

STOCK HOLDING CORPORATION **OF INDIA**

REGISTERED OFFICE

STOCK HOLDING CORPORATION OF INDIA LTD,
301, Centre Point, Dr Baba Saheb Ambedkar Rd, opp. Bharat Mata Cinema, Parel, Mumbai, Maharashtra
400012

PROPOSED CIVIL, FURNITURE, ELECTRICAL, CCTV, DATA AND AIR CONDITIONING WORK OF SATELLITE BRANCH

Situated at 202, 2nd floor, Iconic Shyamal, Satellite, Ahmedabad - 380015
Contact Nos : (Mob) 8866001040

TENDER DOCUMENT

DATE OF SUBMISSION : On or **Before 20 Aug, 2024** 01 PM
DATE OF OPENING : **20 Aug , 2024** 04 PM

ARCHITECT

BIMAL TALATI

304, President House, Opp. C.N. Vidyalaya,
Ambawadi, Ahmedabad – 380 006
M: 94089 94093

STOCK HOLDING CORPORATION OF INDIA LTD
REGISTERED OFFICE

301, CENTRE POINT, DR. BABASAHEB AMBEDKAR ROAD, PAREL, MUMBAI-400012.

TENDER NOTICE

BID NO : Stock Holding_STL_AMD_2024

DATED : 30-Jul -2024

Subject :- Tender Enquiry for PROPOSED CIVIL, FURNITURE, ELECTRICAL, CCTV, DATA AND AIR CONDITIONING WORK OF SATELLITE BRANCH.

We hereby invite you to submit your quotation for above mentioned work. The specifications, special conditions of contract and schedule of work to be carried out is enclosed herewith. you are requested to inspect the site and the nature of work prior to submitting the tenders. You are requested to submit your most competitive offer complete in all respect. We shall be glad to have your application for the said work. Your application shall be uploaded on **GEM Portal Website** <https://gem.gov.in/>.

The approximate cost of the work is Rs. 29,21,850/-without GST.

Tender forms can be downloaded between 30-Jul-2024 to **20-Aug-2024** from STOCKHOLDING's website www.stockholding.com & to be uploaded on GEM Website <https://gem.gov.in/> duly filled and digitally signed. The last date of submission of tenders, duly filled in, is on **20-Aug-2024 01 PM**. The rates shall be filled both in words and figures.

Please prepare the separate Demand Draft for an **Earnest Money Deposit (EMD)** of INR **60,000/-** of the tender value by Crossed Order A/C. Payee, in favor of "STOCK HOLDING CORPORATION OF INDIA", payable at Ahmedabad. **Scanned copy of EMD as prescribed, should be uploaded on GEM Portal Website <https://gem.gov.in/> along with other tender documents.** The EMD to be submitted at the Address mentioned below, ON or Before Last day of submission of BID/application.

Mr. Hemant Patel– Area Admin Operation Manager,
STOCK HOLDING CORPORATION OF INDIA LTD,
Office No. 403, 4th Floor, IFCI Bhavan, C.G. Road,
Ahmedabad – 380 006.

This Earnest Money Deposit shall not bear any interest and shall be forfeited in the event of evasion, refusal or delay on the part of the tenderer to sign & execute the contract on acceptance of his tender. The EMD without any interest will be returned to the tenderer if his tender is not accepted. The EMD for the unsuccessful Service Providers will be refunded only after finalization of the process.

Firms registered under National Small Industries Corporation (NSIC) /Micro, Small and Medium Enterprises (MSME) are exempted from EMD and shall upload the scanned copy of necessary documents. The original demand draft / relevant certificate in this regard needs to be submit on or before last day of submission. Non-receipt of original demand draft / relevant certificate, the Service Provider is liable for disqualification

EMD shall be forfeited in case of failure to provide the services / breach of terms & conditions / revision of any of the prices quoted during the validity period / found to have indulged in fraudulent practices in the bid submission process / withdraw of tender before the expiry of validity period stipulated in the bidding document.

Further EMD of the successful bidder shall be returned on submission of Bank Guarantee of 5% of the Annual contract value.

The rates quoted will include and cover all cost, expenses, liabilities of very description and all risk of every kind to be taken in execution and handing over the work to the Stock Holding. All Taxes, duties and any other taxes applicable and prevailing from time to time on such item for which the same are leviable and the rates quoted by contractor are inclusive of the same.

The Tenderer must check all the pages of the Tender Form at the time of collecting the Tender from this office, If any pages is found missing, it shall be immediately brought to the notice of the Stock Holding, It may be noted that the Tender will be disqualified if any page is found missing after opening the Tender.

Each page of the tender shall bear the signature of the bidder over his name stamp.

STOCKHOLDING reserves the right to accept or reject lowest or any other bid in full or in part and/ or accept any bid other than the lowest in full or in part without assigning any reason, whatsoever. No correspondence will be accepted / entered in this connection and Stock Holding's decision shall be final, conclusive and binding on all.

This tender notice shall form part of the contract and non- submission of tender in the above manner will render your offer liable for rejection.

Thanking you,

Yours faithfully,

Area Operation Manager

STOCK HOLDING CORPORATION OF INDIA LTD

ELIGIBILITY CRITERIA

The intending bidders should fulfil the following minimum eligibility criteria:

1. Contractor should have satisfactorily completed at least **THREE** works of similar nature or any interior work each costing not less than **10 Lacs** cost OR **TWO** works of **25 Lacs** cost OR **ONE** work of **50 Lacs** during the last **FIVE** years with any Central Government Authorities / Public Sector Undertakings / State Government or Local Bodies OR Private Sectors). The successful completion certificate issued by client should contain date of start, date of completion, value on completion of work etc. - Average Annual financial turnover of the firm during the last –3- years, ending 31st March 2024, should be at least ₹15 lacs supported with audited balance sheets.
2. Contractor should have valid **GST Registration No.**
3. Contractor should have valid **EPF/ ESIC Number.**
4. Contractor should have sufficient manpower and resources to carry out such works.
5. Contractor should have an annual average turnover equal to the **15 Lacs** work during the last **Five** Financial Years.
7. The **Stock Holding Corporation of India Ltd.**, has the right to accept or reject any or all applications without assigning any reason whatsoever.
8. The application form shall be submitted Online with duly filled and signed on each page.
9. Tenders will be invited only from those contractors who are prequalified by the Stock Holding in response to the application received for this notice / advertisement.
10. Online application in the prescribed format super scribed with the name of work **“Eligibility Criteria of Interior Contractors for Satellite Branch”**. (Application should be submitted by online only) The application will be opened on **20-Aug-24 04:pm.**
10. The Contractors shall submit their application strictly in accordance with the terms and conditions of this notice.
11. The application shall be signed, wherever provided for on all the pages of the application and shall be initiated at lower right hand by the applicant.
12. Contractors should have registered / Branch office in Mumbai/Gujarat can apply for the eligibility criteria of the contractors for the above jobs.
13. The application shall be signed by a person or persons, so authorized by the applicant with signature duly witnessed. In case of corporation, the application shall be signed by the officer, so authorized by the corporation with its seal duly affixed.
14. The Stock Holding Corporation of India Ltd., reserves the right to reject any prospective application without assigning any reason and to restrict the list to any number deemed suitable by it, if too many applications are received satisfying the basic eligibility criteria.

Yours faithfully,
Area Operation Manager

The Stock Holding Corporation of India Ltd., does not bind itself to accept any application and has the right to refuse any application without assigning any reason.

The Stock Holding Corporation of India Ltd., also reserves the right to re-issue the notice without the applicants having right to object to such re-issue.

This notice shall form part of the contract.

Bidder Information

Please provide following information about the Firm/Company (Attach separate sheet if required): -

Sr. No	Information	Particulars / Response
1.	Firm/Company Name	
2.	Date of Incorporation	
3.	Type of Company [Govt/PSU/Pub. Ltd / Pvt. Ltd/partnership/proprietary]	
4.	Registration No. and date of registration. Registration Certificate to be enclosed	
5.	Address of Registered Office with contact numbers [phone / fax]	
6.	PAN No.	
7.	GSTIN	
	Contact Details of Bidder authorized to make commitments to STOCKHOLDING CORPORATIONINDIA LTD.	
8.	Name	
9.	Designation	
10.	Phone No.	
11.	e-mail ID	
12.	Company Head Office and Addresses - Contact Person(s)- Phone- Fax- E-mail- Website-	
13.	Whether proprietary/partnership /Pvt. Ltd. / Public Ltd. (certificate of registration to be enclosed)	
14.	Name of the Proprietor, Partners, Directors	
15.	Year of establishment	
16.	Any pending or past litigation (within three years)? If yes, please give details. Also mention the details of claims and complaints received in the last three	Yes/No/Comments (if option is 'Yes') (If option is 'Yes' Bidder may Not be considered)

	years (About the Company / Services provided by the company).		
17.	Please mention turnover for last three years and include the copies of Balance Sheet/ Chartered Accountant Certificate on Turn over, in support of it.	Year	Turnover (In Rupees)
		2021-22	
		2022-23	
		2023-24	
18	Registration with Tax Authorities		
a	Income-tax (PAN) No.		
b	G S T No.		
c	TIN / VAT No.		
	copies of certificates of registration with relevant authorities to be enclosed		

Authorized Signatories
(Name & Designation, seal of the Firm/Company)

Date:

Place:

Appendix - "A"

The following works awarded to M/s _____ have been executed satisfactory. (Kindly certify each job on separately)

Sr. No.	Name of Work	Total value of Work (Rs. In Lacs.)	Date of Start	Stipulated Date of Completion	Actual Date of Completion	Whether any compensation levied for delay
1						
2						
3						
4						
5						

The performance of the Firm has been found to be good and they are considered capable of executing the works of magnitude up to Rs. _____ Crores.

The Financial position of the Firm appears to be sound and they are capable of executing works in accordance with the specifications and within specified time schedule.

The dealing of the Firm has been observed to be cordial reasonable and they are not litigious.

Dated

**Signature of
officer-in-charge**

Name of Officer

Mobile No.

Official Seal

If any tenderer submits the experience certificate of ongoing work, then amount of work done against the agreement is to be mentioned clearly in the certificate.

Appendix - "B"

List of Projects executed by the Organization during the last 5 Years
Costing as per terms in Eligibility Form

Sr. No.	Name of Work / Project with Address	Name and Postal address of the owner. Specify if Govt. undertaking along with name add. & Contact nos. of 2 persons (Exec. Eng. or top officials of the organization)	Contract Amount (Rs.) with copy of work order & completion certificate from Project In charge.	Stipulated time of completion (Month)	Actual time of Completion (Months)	Any other relevant information if actual amount of Project if increased (Give reasons.)	Enclose client's certificate of satisfactory completion	Remarks

Notes:

☑ Information has to be filled up specifically in this format. Please do not write remark "Indicated in Brochure"

☑ For Certificates, the issuing authority shall not be less than an Executive in charge.

Appendix - "C"

List of Important Projects in Hand
Costing as per terms in Eligibility Criteria Form

Sr. No.	Name of Work / Project with Address	Name and Postal address of the owner. Specify if Govt. undertaking along with name add. & Contact nos. of 2 persons (Exec. Eng. or top officials of the organization)	Contract Amount (Rs.) with copy of work order & completion certificate from Project In charge.	Stipulated time of completion (Month)	Present Status of the Project	Any other relevant information

Notes:

☐ Information has to be filled up specifically in this format. Please do not write remark "Indicated in Brochure"

INTRODUCTION

1. NAME OF THE CLIENT OFFERING CONTRACT	STOCK HOLDING CORPORATION OF INDIA LTD
2. ARCHITECT	ARCHITECT BIMAL TALATI
3. SITE ADDRESS	SATELLITE BRANCH 202, 2nd Floor, Iconic Shyamal, Satellite, Ahmedabad - 380015
4. SCOPE OF WORK	INTERIOR WORK OF SATELLITE BRANCH (Furniture & Civil Work, Electrical, Data & AC Work)
5. A. DATE OF DISPLAY ON WEBSITE B. ISSUE OF TENDERS C. SUBMISSION OF TENDERS D. DATE OF OPENING OF TENDERS	<u>30- JUL 24 TO 20 AUG 2024</u> ON STOCK HOLDING WEBSITE AND GEM PORTAL PLATFORM (E TENDER). <u>ON OR BEFORE 20 AUG 2024 01:00 PM</u> ON 20-AUG- 2024 04:00 PM AT STOCKHOLDING
6. TIME LIMIT FOR EXECUTION	45 DAYS
7. EARNEST MONEY DEPOSIT	<u>60,000/- INR</u>
8. PERFORMANCE BANK GUARANTEE	5% OF ACCEPTED VALUE OF TENDER LESS MONEY MONEY DEPOSITED.
9. RETENTION	8% OF EACH INTERIM BILL VALUE. Up to total 8% retention is to be release after End of DLP
10. DEFECT LIABILITY PERIOD	12 MONTHS FROM DATE OF COMPLETION OF WORK
11. INSURANCE	100% OF CONTRACT VALUE
12. PENALTY OF DELAY	1% OF THE CONTRACT SUM PER WEEK MAXIMUM AMOUNT OF LIQUIDATED DAMAGE WILL BE 10% OF COST OF WORK.
13. PAYMENT OF R.A. BILLS	VALUE OF 1 ST RUNNING BILL SHALL NOT BE LESS THAN 40% OF TOTAL CONTRACT AND REMAINING BILLS NOT LESS THAN 30% EACH.

To,
The AREA ADMIN OPERATION Manager,
STOCK HOLDING CORPORATION OF INDIA LTD
Office No. 403, 4th Floor, IFCI Bhavan, C.G. Road,
Ahmedabad – 380 006.

Dear Sir,

LETTER OF OFFER

Sub.: - Tender enquiry for PROPOSED CIVIL AND FURNITURE, ELECTRICAL AND AIRCONDITIONING WORK OF SATELLITE BRANCH.

With reference to the tenders regarding the above work invited by you, we have to state as under.

We declare that before quoting the rates, we have visited the site and our rates are as per present site condition, Further we herewith deposit EMD (**Rs. 60,000**) as Earnest Money for due execution of the works at my / our tendered rates as per the Terms of Contract. In the event of this tender being accepted, I / We agree to enter into and execute the necessary contract documents as required by you.

As required by you, I / We are returning herewith the documents (in single) duly signed by us at each page in token of our acceptance of the provisions in the documents.

We hereby after to execute and complete the whole of the works strictly in accordance with the said conditions of contract, special conditions of contracts, specifications and drawings at the rates set out against each of the items of work in the schedule of quantities.

We have carefully read and clearly understood the conditions of contracts, special conditions of contract, and specifications. We agree to complete the work at the rate \ rates quoted by me \ us in the schedule of quantities and within the specified time from the date of work order awarding the work to us.

We understand the work is to be completed within scheduled time period.

Our rates are firm and include and cover all cost, expenses, liabilities of very description and all risk of every kind to be taken in execution and handing over the work to the Stock Holding. All Taxes, duties, municipal tax, general tax and any other taxes applicable and prevailing from time to time on such item for which the same are leviable and the rates quoted by us are inclusive of the same.

Thanking you,

Yours faithfully,

NAME : _____
ADDRESS ; _____

TELE. NO. : _____
FAX. NO. ; _____
MOBILE NO. : _____

TENDER FORM

The general Terms and Conditions that are more particularly set out herein below for the purpose of appointing contractors for the purpose of carrying out Interior Work at SATELLITE BRANCH of STOCK HOLDING OF INDIA LTD and other ancillary activities which is herein after referred to as “the said work”. The definition and interpretation of the certain classes are more particularly set out hereunder.

DEFINITIONS: -

“THE SAID WORK” includes all items of Interior Work at SATELLITE of STOCK HOLDING CORPORATION OF INDIA LTD with bill of quantities, general terms & conditions / special conditions / technical conditions

1. The “STOCK HOLDING” shall mean the “STOCK HOLDING CORPORATION OF INDIA LTD” having its registered address at STOCK HOLDING CORPORATION OF INDIA LTD, Office No. 301, Centre Point, Dr Baba Saheb Ambedkar Rd, opp. Bharat Mata Cinema, Parel, Mumbai, Maharashtra 40001 and authorized representative(s) of the STOCK HOLDING to discharge all or any of its function.
2. The “CONTRACTOR” shall mean the individual or firm or Company, whether incorporated or not who is assigned the subject work, and shall include the personnel representative/ (s) of such individual person, firm or company of such individuals or firm or Company, successors and permitted assigns. The work contractor shall include “Sub-Contractor” if expressly permitted by the Stock Holding in writing.
3. The “ARCHITECT / ARCHITECT” means the authorized person or persons nominated by the STOCK HOLDING for the purpose of the contract, who shall inspect, direct, Supervise, measure and issue certificates in respect of the said work and be in charge of the work for the purpose of this contract. It also includes any person claiming through or under them.
4. The “CONTRACT” means instructions to Contractor, Tender, the written acceptance thereof, a form agreement between ‘STOCK HOLDING’ and ‘CONTRACTOR’ (where completed) to execute the works as per conditions and specifications set in this document including Bill of Quantities.
5. The “SPECIFICATION” means specification referred to includes General, Special and Technical specifications (with drawings if any) and any modification thereof or addition thereof as many from time be furnished or approved in writing by the Architect / STOCK HOLDING.
6. The “CONTRACT PRICE” means the sum named in the tender subject to additions or deductions there from as the case may be.
7. The “PLANT & EQUIPMENT” of the contractor shall mean all plants, machinery, equipment, pipe work services and all other things to be provided, erected, commissioned and maintained in accordance with Contract.

ELIGIBILITY FOR TENDERING & GENERAL CONDITIONS OF CONTRACT

1. The tender must be uploaded on GEM Portal Website <https://gem.gov.in/> duly filled and digitally signed on each page. Tenders will be received on 20 Aug 2024 01: 00 PM
2. The tenderer should visit the site and acquaint himself with the site conditions and should study all the tender documents carefully and understand the tender contract conditions, specifications etc. before quoting. If there are any doubts they should get clarification in writing.
3. Late tenders i.e. tenders submitted / received after on 20 Aug 2024 01: 00 PM will not be considered.
4. The tender documents are non-transferable.
5. All the entries in the tender documents must be made in English and all entries must be by hand and written ink. If any of the document is missing or unsigned, the tender may be considered invalid by the STOCK HOLDING in its discretion.
6. The tenderer should quote the rate and amount for the assessed quantities (area) of each item. The rates for each item should be written both in figures as well as in words. Erasures, alteration, and overwriting must be avoided. Wrong figures and words, if any, should be scored out and the correct figures and words neatly written authenticated by the signature of the tenderer. No advice of any change in rates or conditions after opening the tender will be entertained.
7. In the event of any discrepancy in the rates quoted in words and figures, the former shall be prevailed. Mathematical computation error, if any, in the amount shall however be rectified.

8. The STOCKHOLDING has assumed that Contractor is fully aware of all items of work. Some items of work will be done simultaneously and some items will be done in sequence and different operations in different times.
9. The Contractor is responsible for the due and proper execution of all the works, terms and conditions stipulated under this contract. Before offering his tender, Contractors should visit the site of works to ascertain the nature of work and to collect all relevant information such as general, local, physical & climatic conditions of the site, availability, handling and storage of materials, water, electricity, availability of labour, roads, the configuration of the ground. Any failure on the part of the Contractor in this regard shall not absolve him from any responsibilities or obligations under this contract and no claim whatsoever on account of these shall be entertained.
10. On receipt of intimation from the STOCKHOLDING for the acceptance of his/ their Tender, the successful Tenderer shall be bound to implement the Contract and within one days thereof, the successful Tenderer shall sign an agreement if called upon to do so, but the written acceptance by STOCKHOLDING of a Tender will constitute a binding contract between STOCKHOLDING and the person so tendering, whether such formal agreement is or is not subsequently executed.
11. The tenderer should note that unless otherwise stated, the Tender is strictly on item rate basis and his attention is drawn to the fact that rates for such a every item should be correct, workable and self –supporting. The quantities in the Schedule of Quantities approximately indicated the total extent of work, but may vary and even be omitted thus altering the aggregate value of the Contract. No claim for any compensation shall be entertained in this regard.
12. The tenderer must obtain all the information which may be necessary for the purpose of tendering for himself, on his own responsibility and at his own expenses and for entering into a Contract must inspect the Site of the work and all matters pertaining thereto, regarding supplying, fabricating and erecting at Site without any damage to the existing property of the Client's or their neighbors, if any.
13. STOCK HOLDING CORPORATION OF INDIA LTD does not bind itself to accept the lowest or any tender and reserves to itself the right to accept or reject any or all the tenders either in whole or in part, without assigning any reasons for doing so. No variation in rates shall be allowed on this account under any circumstances, whatsoever no correspondence will be accepted / entertained in this connection and Stock Holding's decision shall be final conclusive and binding on all.
14. The rates shall be firm and shall not be subject to exchange variations, Labour conditions, fluctuations in Railway Freights or any conditions whatsoever.
15. The rates quoted by the tenderer in the schedule of quantities will be deemed to be for the finished work and shall include all charges for:
 - i. Design, Fabrication, supply and installation at Site, Labour, maintenance, fixing, arranging, cleaning, making good, hauling etc.
 - ii. Plant, double, scaffolding, frame work, ladders, ropes, nails, spikes, tools, materials, workmen, protection from weather, temporary support, platform, and maintenance of the Same. Insurance for Labour materials and third party.
 - iii. All Taxes or any other levy imposed by Central Government or State Government or any Local Authorities.
 - iv. Packing, transportation, loading and unloading, freight charges, transit
 - v. Covering for the walling and other works during inclement weather or strikes or whenever Directed, as necessary.
 - vi. All temporary canvas, lights, tarpaulin, barricade, water shoots etc.
 - vii. All measures required to be taken for protection of existing works.
 - viii. All such temporary weather-proof sheds at such places and in a manner approved by the Architect for the storage and protection of materials against the effects of sun and rain.
 - ix. Testing of materials.
 - x. No tools and plants shall be issued by the Corporation under the Contract.
16. All the payments of bills for the work shall be done only at SATELLITE BRANCH, by the Branch Manager after sanction from REGISTERED OFFICE OF STOCK HOLDING CORPORATION OF INDIA LTD.
17. For any clarification in any item of work, The contractor should get the same from the Architect before carrying out the work and all items of work should be carried out with the approval of the STOCK HOLDING

EARNEST MONEY DEPOSIT

1. The tenderer is required to deposit EMD (Rs 60,000/-) in the form of a Demand Draft drawn in favor of “**STOCK HOLDING CORPORATION OF INDIA LTD**” and submit the Demand Draft along with the tender. Tenders unaccompanied by the requisite Earnest Money Deposit will be summarily rejected.
2. 100 % of the retention amount shall be refunded to the contractor on virtual completion subject to the following:
 - i. Issue of Virtual completion Certificate by the Architect/Premises Department.
 - ii. Contractor's removal of his surplus materials, equipment, Labour force, temporary sheds /stores etc. from the site. (Excepting for a small presence required if any for rectification during defect liability period and approved by the STOCK HOLDING).

3. Defects liability period: Defects pointed out during the defects liability period of 12 (Twelve) months from the date of virtual completion of work, will be satisfactorily rectified by the contractor at no extra cost to the Stock Holding with end satisfaction.
4. No interest shall be payable on the EMD/SD amount.
5. No payment will be made towards mobilization Advance.

VALIDITY OF TENDER BID

1. The tender rates shall remain valid for a period of 90 days from the date for receipt of tender.
2. The tendered Rates shall remain firm during the contract period and no price escalation shall be permitted,

STOCKHOLDING'S RIGHT OF ACCEPTANCE OF BIDS.

The STOCKHOLDING does not bind itself to accept the lowest or any tender and reserves to itself the right to accept or reject any or all the tenders either in whole or in part, without assigning any reasons for doing so.

STOCKHOLDING also reserves the right to divide the work between two or more tenderers and the successful tenderers shall have to carry out even part orders for various items at quoted rates. No variation in rates shall be allowed on this account under any circumstances, whatsoever no correspondence will be accepted / entertained in this connection and STOCKHOLDING's decision shall be final conclusive and binding on all.

BID, QUANTITIES / MEASUREMENTS.

1. Price bid shall be quoted for all the items described in the schedule of quantities. Price quotation for part items of the schedule shall not be accepted and such tender shall be summarily rejected.
2. No payment shall be made for the personal visit for assessing the quantities/ measurements for the preparation of the tender bid.
3. Quantities / measurements for which the bid for various item is submitted shall be given precisely in the schedule of Quantities, these quantities and measurements shall be based on the basic of personal assessment and physical verification at site.
4. The Contractor shall calculate realistic quantities after receipt of drawings and after submitting first interim bill but before submitting the second interim bill to Stock Holding.
5. Any work done at factory will not be counted in the running accounts bill until the material is brought on site.
6. Excess quantity shall not be executed without written permission from STOCK HOLDING. In case of upward or downward revision in quantities of items, the rate quoted by the Contractor shall remain firm at all the times.
7. The contractor shall take joint measurements with the Architect/STOCK HOLDING representative before covering up or otherwise placing beyond the reach of measurement any item of work should the contractor neglect to do so, the same shall be uncovered at contractor's expense or in default thereof, no payment or allowance shall be made for such work or the materials with which the same, was executed.
8. In case of any class of work over which there is no specification mentioned, the same shall be carried out in accordance with the latest Indian Standard Specifications subject to the approval of the Architect / Stock Holding.

DIMENSIONS:

1. Figured dimension are to be followed in all cases, large scale details take precedence over small scale drawings, In general the drawings shall indicate the dimensions positions and type of construction, the specification shall indicate the qualities and methods, and the bill of quantities shall indicate the quantum and rate for each item of work.
2. Any work indicated in the drawings and not mentioned in the specifications or vice-versa shall be furnished as though fully set forth in both. Any ambiguity, conflict of interpretation, errors or inconsistencies discovered in the drawings / documents shall be promptly brought to the provisions giving more rigorous interpretation shall prevail but in the event of disagreement between the contractors and the supervisors, decision of ARCHITECT shall be final In case of any discrepancy, the contractor is to ask for an explanation before proceeding with the work. However, specifications will prevail over the drawings.

OBSERVANCE / COMPLIANCE OF LABOR LAWS AND OTHER STATUTORY PROVISIONS FOR THE CONTRACT

1. The contractor shall, in the execution of the contract, be responsible to comply with all the labor laws & statutory provision governing the work, such as, but not limited to, the following Laws or any other act or enactment relating thereto and rules as amended up to date.
 - a. Contract labor (Regulation & Abolition) Act. 1970. The Contractor shall submit a copy of the license obtained under this act along with the bid.
 - b. Employees State Insurance Act for Security and Insurance of staff/ workers.
 - c. Payment of Wages Act.
 - d. Minimum wages Act, 1948.
 - e. Workmen's Compensation Act.
 - f. Industrial Disputes Act.
 - g. Bank's Liability Act

The Contractor shall abide by and adhere to all labour laws, PF, ESIC, etc. The Contractor shall work only on and during hours of working day unless he obtains prior approval of the Architect / STOCKHOLDING. The Contractor will observe and abide by the rules and regulations of the public Authorities regarding overtime, night working and any particular rule regarding nuisance to the residence that may result there from.

2. The works to be carried out under the contract shall, except as otherwise provided in these conditions, include all labor, supervision, materials, tools, tackles, plants, equipment, transport, lead/ lift of materials etc. as may be required for execution and completion of the works.
3. The materials used for the work shall be of prescribed quality / standard and the work executed according to the prescribed specification. Materials and mix not being of the specified standard / specification shall be rejected at the cost of the contractor.
4. After completion of work all accumulate debris, dirt etc. shall be removed and disposed away from the STOCKHOLDING premises by the contractor at his expense and no payment shall be done / made for that.
5. Doors, Windows, Staircases and passages shall be cleaned / washed by the contractor as part of the contract work without any additional payment.
6. The debris shall be removed from the site every three days.
7. The contractor shall clean the site every day before the closure of work.
8. No additional work is to be carried out by the contractor unless instructed by the STOCKHOLDING through Architect. The contractor will have to carry out the item of work with prior permission from STOCKHOLDING and as per instruction from Architect which may not have been specified in tender but necessary for completion of job.
9. Any extra item of work carried out other than specified in tender will be paid by the STOCKHOLDING as per the actual expenses and 10% for overheads and profit certified by Architect.

INCOME TAX

1. The bidder shall indicate his Income Tax PAN/GIR Number.
2. Income Tax @ of the amount of each payment shall be deducted and deposited with the Government as per Current Statutory provision if applicable. On completion of the work, a certificate for the Income Tax deducted at source given to the contractor.

DOCUMENTS TO BE COMPLEMENTARY

All sections of contract document and working drawings shall be complementary to each other. In case of ambiguities, discrepancies or contradictions between any two sections. Stockholding's / Architect's decision shall be final and binding on the contractor for interpretation of same.

COMPLETION PERIOD

Time is the essence of the contract and the contractor is required to complete the entire work to the satisfaction of the STOCKHOLDING in 45 DAYS from the date of commencement of work.

PROGRAM WORK AND PROGRESS REPORTS

The successful contractor will have to submit a detailed bar-Chart indicating the schedule of various activities from the date of commencement till completion and get the same approved by Architect. Contractor shall strictly adhere to the same. This program shall form part of contract and shall be binding on the contractor. However, the STOCKHOLDING reserves the right to alter the Program, if necessary, from time to time, No claim whatsoever of any nature by the Contractor on this account shall be entertained by STOCKHOLDING. They shall also have to write their requirements about co-ordination from other agencies working at site.

WATER & ELECTRICITY REQUIREMENT

1. The Contractor will be permitted to draw and use water from STOCKHOLD's U/W Tank and O/W Tank. He will not claim any compensation for late, intermittent and no supply of water. At the time of shortfall, the Contractor will arrange water without any extra cost. The Contractor has to arrange 'Sintex' tanks of adequate capacity to store water and pumps and pipes for distribution of water from tanks to work place free of charge. The site for storage and distribution of water will be decided by the owner / STOCKHOLDING.
2. The Contractor will be provided Electricity at one point by the STOCKHOLDING 0.5% of bill, only most convenient to the STOCKHOLDING. He will also ensure that all safety measures are adhered to at his costs. The Contractor will not make any wastage of this facility nor will claim any compensation for late or intermittent supply for electricity. Cost of power shall be borne by the STOCKHOLDING. Any accidents, mishaps, etc. due to fault and negligence of Contractor's workmen, the Contractor will be responsible and indemnifies and keep indemnified the members of the managing and repair committee and the STOCKHOLDING.

DELAY IN COMPLETION OF WORK

1. Liquidated damages per week will be 1% of the contract value inclusive of non-completion of work in time including Sundays and holidays per week, subject to maximum of 10% of contract value. The STOCKHOLDING may without prejudice to any other mode of recovery deduct the amount of such damages from any moneys in his hands due or which may become due to the Contractor. The payment or deduction of such damages shall not relieve the Contractor of his obligations and liabilities of this contract.
2. If in the opinion of the STOCKHOLDING / Architect, the works gets delayed due to causes which the STOCKHOLDING may consider being beyond the control of the contractor, the STOCKHOLDING at the completion of the time allowed for the contract shall make fair and reasonable extension of time for completion in respect thereof. For extension of time for completion, the contractor has to apply in writing with detail reasons.

PAYMENT SCHEDULE

1. Bill in Triplicate duly Certified by Architect shall be submitted to STOCKHOLDING after satisfactory completion of the work. Payments to the contractor shall be made within 15 days of submission of each "on account" bill. Bill submitted by the contractor must contain item wise quantity of work done in a manner that verification of work done can be done. The quantities for which the bills are submitted shall be subject to physical verification before payment.
2. In the event of variation in the Quantity / Area, the payment shall be made on the basis of the actual Quantity / Area at the quoted Rate.
3. No interest will be given for late payments.
4. All payments to the Contractor shall be made subject to deduction of taxes at source at the rate applicable.
5. Final payment, except Security Deposit (which is to be released only after the defect liability period including observing the performance of water proofing during the rainy season) shall be made within 30 days from the submission of the final bill after verification of the completion of the work. No further claim except the security Deposit after the submission of the FINAL BILL shall be accepted.
6. For final payment, the Contractor will submit details of all items, payments received for works and materials, any claim and net balance due which Architect/ STOCKHOLDING will check, make any adjustments if any, will receive 'No Claim' from the Contractor and pay and settle the same if any.
7. The Contractor will submit original certificate for payment of Works Contract Tax in respect of the Owner / STOCKHOLDING or else the same will be deducted from his bills.
8. The decision of the Architect and repair committee for payment or for any extra work to be made or any deduction to be made from the whole cost of the work or any other matter whatsoever relating to the contract shall be final and binding to all parties.
9. The Contractor shall be liable to pay Rs. 500/- per day as penalty in the event of default for any reason whatsoever in the removal of debris and / or materials and / or tools and / or plants and / or equipment within 7 days from the written instructions given to contractor to do so till such removal takes place. The STOCKHOLDING may without prejudice to any other mode of recovery deduct the amount of such damages from any moneys in his hands due or which may become due to the Contractor. The payment or deduction of such damages shall not relieve the Contractor of his obligations and liabilities of this contract.

SUBLETTING

The selected contractor shall not sub-contract the work to any other individual, Agency or firm.

DEFECTS IN WORK

REQUEST FOR PROPOSAL

SIGNATURE AND SEAL OF CONTRACTOR

16

1. Any defects / deficiency pointed out by the STOCKHOLDING's authorized person(s) shall be removed / rectified to his / their satisfaction, otherwise payment for such items(s) shall not be passed till the defect/ discrepancy is removed / rectified by the contractor.
2. The Architect shall have the power to withhold any certificate of work and/ or part thereof not being carried out to his satisfaction and he can make the necessary corrections in previous certificate in any subsequent certificates.
3. In case the Contractors are disobeying Architect/ STOCKHOLDING, they may get bad work replaced in the manner the Architect think fit at the cost and consequences of the Contractor.
4. The Architect/ STOCKHOLDING shall have the right to alter, omit and abandon any part of work without invalidating the contract. If any work is over and above that included into the Contract and is required to be executed at site, the Architect/ STOCKHOLDING has power either to delegate this work to Contractor as an extra item or to any outside Contractor, as the case may be.

SECURITY OF WORKS / MATERIALS / STORES ETC. OF THE CONTRACTOR AND STOCK HOLDING'S PROPERTY

1. The Contractor shall be responsible to make safety arrangements at his own cost for his materials / stores, storages, etc. All such stores shall be cleared away and the ground left in good and proper order on completion of this contract unless otherwise expressly mentioned therein.
2. The STOCKHOLDING will provide the contractor open space for storing the cement. The area has to be maintained by the Contractor during the period of work. He can construct a temporary shed and he alone will be responsible for his materials.
3. All stores and materials brought to the site shall become and remain the property of the STOCKHOLDING and shall not remove from the site without prior written approval of the STOCKHOLDING. When the work is finally completed or the contract is determined for reason other than default of the Contractor, he shall forthwith remove the same from site.
4. All tools, plant and equipment brought to site by the Contractor shall not be removed from the site without prior written approval of the STOCKHOLDING. When the work is finally completed or the Contract is determined for reason other than default of the Contractor, the Contractor with prior written permission of the STOCKHOLDING shall forthwith remove the same from site all tools, plant and equipment.
5. For any damage / injury to the STOCKHOLDING's property or to any member of the STOCKHOLDING or to the members property on account of any unsafe practices adopted or by any un-prudential action by the Contractor or by his men, the contractor shall be responsible. STOCKHOLDING reserves the right for recovering proper remedy / compensation for the same from the contractor.
6. Contractor should indemnify and keep indemnified the STOCKHOLDING against any legalities arising out of labour rules, local authorities' rules etc. during the execution of work and any losses and claims for injuries or damage to any person or any property and should take third party insurance in the joint name of Stock Holding and contractor.
7. The Contractor shall ensure protection to the STOCKHOLDING flat owners, occupiers of the Organization, other properties near site and to the public in general. The approach is kept free at any time.
8. The contractor must take all measures and precautions to prevent death / injury to his own labors or any other person and shall take THIRD PARTY (Public Liability) Insurance Policy in the joint name of STOCKHOLDING and contractor at his own expenses. This will be comprehensive and all risks covered to safeguard all men, materials and property during and on account of the execution of work under this contract and will submit certified copy to employee.
 - a. All Risk Policy with accidental cover to neighboring property due to work of contractor's workmen.
 - b. Workmen's Compensation Policy.
 - c. Automobile Third Party Insurance with unskilled third-party liability of his vehicles or his suppliers or debris removal vehicles, etc. damaging any cars, etc. while bringing, removing materials, etc.
9. The contractor shall, if required by Architect / STOCKHOLDING, arrange to test materials and / or portion of the work at his own cost in order to prove their soundness and efficiency. If after any such test, the material or portion of work is found, in the opinion of the Architect and STOCKHOLDING to be defective or is found, in the opinion of the Architect and STOCKHOLDING to be defective or unsound, the contractor shall pull down and re-erect the same at his own cost. Samples of materials and workmanship shall be submitted by the contractor for the approval of the Architect / Stock Holding before procurement and execution.
10. Contractor shall submit written performance guarantee from the manufactures of all bought out items.
11. The Contractor shall submit original copies of invoices, order forms for any materials purchased for project work, to the STOCKHOLDING / Architect if called for.

CONTRACTOR'S SUPERVISION

1. The Contractor shall give and provide all necessary superintendence during the execution of work and as long after as Architect / STOCKHOLDING may consider necessary for proper fulfilling of Contractor's obligations under the contract. The Contractor shall himself supervise the execution of contract and shall appoint a full time competent agent (site engineer / supervisor) approved by the Architect / STOCKHOLDING to act on his behalf and to be present all throughout at site. The Contractor shall further employ engineers and assistants to the above to supervise the work in sufficient numbers to the satisfaction of Architect / STOCKHOLDING. These engineers must be completely authorized by the Contractor to represent him and to receive and execute order and instructions by the Architect / STOCKHOLDING as if Contractor himself is present. The Contractor shall visit the site daily and shall have minimum once a week, or more as the case may be, joint meeting with the Architect & STOCKHOLDING on a day fixed jointly by the Architect and the STOCKHOLDING.
2. The Contractor shall provide and employ on site in connection with the execution and maintenance of the works:
 - a) Only such assistance's as are skilled and experienced in their respective fields and qualified and such agents, foreman and leading hands as are competent to give proper supervision to the work.
 - b) Such skilled, semi-skilled and unskilled labour as is necessary for the proper and timely execution and maintenance of the work.
 - c) The contractor shall employ a whole time qualified and competent supervisor for the work, whose name shall be notified and who shall interface with the STOCKHOLDING's representative(s) for the ongoing contract work.
3. The Architect / STOCKHOLDING shall be at liberty to object any Contractor man / men, employed by him, for misconduct or is incompetent or negligent in the proper performance of his duties or whose employment is otherwise considered by the Architect / STOCKHOLDING to be undesirable to work within the premises of STOCKHOLDING. Any person so removed from the works shall be replaced immediately by a competent substitute.

INSURANCE:

The contractor shall obtain adequate insurance cover at his own cost for work against any loss or damages as well as workman compensation and third party risk, until the date of virtual completion of the work, The insurance cover shall be in joint names of the owner and the contractor, is to be deposited with the owner within 21 (twenty one) days from the date of issue of work order.

OCCUPATION OF PARTIALLY COMPLETED PORTION BY THE STOCK HOLDING:

The STOCKHOLDING shall be entitled to and will be at liberty to occupy even the partially completed portion of the work by themselves or through their agents and servants if they so desire. Necessary extension of time for completing the work shall have no claim for any compensation whatsoever due to the delay, if any involved in completing the work on account of partial occupation.

MOCK UP:

The Contractor shall prepare a mock-up of items, if required, strictly in accordance with the specification, free of cost, for approval of Architect and STOCKHOLDING. The work on these items shall proceed further only after the approval of the mock-up.

UNSCHEDULED ITEMS OF WORK

1. Work should be carried out strictly as per the standard specifications given in Tender document and the directions of the Engineer Workmanship / Work of substandard nature will not be accepted and paid for.
2. Any work carried out as per specifications and found defective in opinion of architect / consulting engineer / stockholding officials shall be demolished are replaced by new work by contractor to the satisfaction of architect / consulting engineer at no extra cost.
3. If change in any item or additional work is to be carried out while executing the job by the contractor will be executed with prior consent from the STOCKHOLDING and as per instruction from Architect which may not have been specified in tender but necessary for completion of job.
4. In case of any dispute the decision of STOCKHOLDING will be final and binding on the contractor.
5. The Contractor shall comply with all acts and regulations for the successful completion of the contract works and shall give due notice and pay all fees / taxes etc. as per statutory requirements.
6. No additional work is to be carried out by the contractor unless instructed by the STOCKHOLDING through Architect.
7. All materials to be delivered at site. If the material used for the work is not in conformity with the specifications, the same shall be replaced at your cost. All the material required for the above work shall be arranged by the contractor at his own cost.

8. Selection of material to be done in consultation with the STOCKHOLDING's representative / Engineer. The Contractor shall, if required by Architect/ STOCKHOLDING, arrange to test materials and / or portion of the work at his own cost in order to prove their soundness and efficiency. If after any such test, the material or portion of work found, in the opinion of the Architect and STOCKHOLDING to be defective or is found, in the opinion of the Architect and STOCKHOLDING to be defective or is found, in the opinion of the Architect and STOCKHOLDING to be defective or unsound, the Contractor shall pull down and re-erect the same at his own cost. Samples of materials and workmanship shall be submitted by the contractor for the Approval of the Architect / STOCKHOLDING before procurement and execution.
9. Rules for varied/deviated or extra items to be worked out on the rates quoted in the Tender for the similar items. Wherever it is not possible to base the rates for varied/ deviated or extra items on Tender quoted rates then the rate analysis is to be submitted by the contractor will include the actual cost of material, Taxes, Transportation if any, Miscellaneous expenses, labour, Wastage of materials, 15% towards contractors overheads and profit.
10. STOCKHOLDING will provide free Electricity and Water for the execution of work. However, the Contractor shall make his own arrangement to draw the power and water from source as decided by STOCKHOLDING.
11. While executing the work the contractors have to ensure that no inconvenience whatsoever is caused to the offices / people functioning in the premises.
12. On completion of the work the contractor shall clear away and remove from the site all constructional plant, surplus materials, rubbish and temporary works of every kind and leave whole of the site and the works clean and in a workman like condition to the satisfaction of client. No extra payment will be made for this purpose. After completion of work all accumulated debris, dirt etc shall be removed and disposed away from the Stock Holding premises by the contractor at his expense. The Contractor shall take due care while disposing of such waste materials and ensure that any rules / regulations laid down by Municipal Corporation or any other statutory body are not violated. The Contractor shall be responsible and answerable to any complaint arising out of improper disposal of waste material.
13. Doors, Windows, Staircases and passages shall be cleaned / washed by the contractor as part of the contract work without any additional payment. The contractor shall clean the site every day before the closure of work.
14. Adequate number of fire extinguishers, first aid boxes, must be provided on the site by the contractor.
15. Any item work which is not specified in the schedule and which is not capable of assessment by sight (visual) inspection and which becomes known only after the contract work has commenced, such as broken/ leaky pipes, cracks in walls, seepage. Percolating through the walls, beams / pillars etc shall be, on joint inspection, by the STOCKHOLDING and Contractor, assessed for quantum and the rate decided on mutual consultation.

VARIATIONS

1. The Architect/ STOCKHOLDING shall make any variations of the form, quality or quantity of the works or of any part thereof that may in their opinion be necessary and for that purpose or for any other reason it be necessary, the Contractor shall do any of the following:
 - a) Increase / decrease/ omit any work
 - b) Change, character, quality, level, lines, position, dimensions etc.
 - c) Execute additional work of any kind as may be necessary for completion of the work.
2. And no such variation shall in any way vitiate or invalidate the contract but the extension of proportionate time limit, if any, for all such variations shall be taken in to account.
3. The Contractor shall make no such variations without an order in writing by Architect / STOCK HOLDING.

CANCELLATION OF THE CONTRACT OR PART OR FULL ON CONTRACTOR'S DEFAULT:

If the Contractor shall at any time:

- a) Become bankrupt or insolvent.
- b) Make an arrangement without assignment in favor of his creditors or agree to carry out the contract under the committee of Inspection of his creditors.
- c) Being an individual / partner / company or corporation go in to liquidation.
- d) Have action levied on his goods or property on the works.
- e) Assign the contract or any part thereof otherwise than as provided in the general condition of the Contract.
- f) Abandon the Contract.
- g) Persistently disagree the instructions of the Architect / STOCKHOLDING and or contravene any provisions of the contract including general accepted principles of working.
- h) Stopping the work under flimsy excuse with threatening attitude or showing discourtesy to members so the majority members wish this.

In that case, the STOCKHOLDING may determine and terminate the contract after giving due notice and time to the Contractor. The Corporation shall be entitled after giving due notice in writing for removal of the Contractor from whole or any portion of work, without avoiding the Contract or releasing the Contractor from any of his obligation or liabilities under the Contract and adopt any or several of the following measures:

- I. Rescind the Contract, in which case the security deposit of the Contractor shall stand forfeited to the STOCKHOLDING without prejudice to Stock Holding Corporation's right to recover any amount from Contractor,
- II. Carry out the work or any part thereof by employing other agency and required labour and materials and debiting on Contractor's account.
- III. Measure up the work executed by the Contractor and to get the remaining work completed by another contractor at the risks and expenses of the Contractor. In the event of any several of the courses referred above being adopted.
- IV. Upon non-completion of the work, upon use of sub-standard quality, upon non-co-operation, upon a deadlock on a particular issue between the Owner/ STOCKHOLDING and the Contractor / Architect.
 - a. The contractor shall have no claim for compensation for any loss sustained by him by any reason for material purchased by him, tools, machinery, and labor to retain the same in further execution of the work for wear, tear and destruction caused by his negligence.
 - b. The Corporation shall be entitled to take possession of any materials, tools, machinery, equipment which was on site, as if those are the property of STOCKHOLDING to carry out the balance work, In this case Contractor is not entitled for any compensation for use and employment of the same.

ARBITRATION CLAUSE

All disputes or differences of any kind whatsoever which shall at any time arise between the parties hereto touching of concerning the work or the execution or maintenance thereof of this contract or the right touching of concerning the works or the execution or maintenance thereof of this contract or the construction, remaining operation or effect thereof or to the rights or liabilities of the parties or arising out of or in relation thereto whether during or after determination, foreclosure or Branch of the Contract (other than those in respect of which the decision of any person is by the contract expressed to be final and binding) shall after written notice by either party to the contract to the other of them and to the Appointing Authority who shall be appointed for this purpose by the STOCKHOLDING, be referred for adjudication to a sole arbitrator to be appointed as hereinafter provided.

For the purpose of appointing the sole Arbitrator referred to above, the Appointing Authority will send within thirty days of receipt by him of the written notice aforesaid to the Contractor, a panel of three names of persons who shall be presently unconnected with the organization for which the work is executed.

The contractor shall on receipt by him of the names as aforesaid, select any of the persons named to be appointed as a sole Arbitrator and communicate his name to the Appointing Authority within thirty days of receipt by him of the names. The Appointing Authority shall thereupon without any delay appoint the said person as a sole Arbitrator, if the contractor fails to communicate such selection as provided above within the period specified, the Appointing Authority shall make the selection and appoint the selected person as the sole Arbitrator.

If the Appointing Authority fails to send to the Contractor the panel of three names as aforesaid within the period specified, the Contractor shall send to the Appointing Authority a panel of three names of persons who shall all be unconnected with either party. The Appointing Authority shall on receipt by him of the names as aforesaid selected any one of the persons named and appoint him as the sole Arbitrator. If the appointing authority fails to select the person and appoint him as the sole Arbitrator within thirty days of receipt by him of the panel and inform the contractor accordingly, the contractor shall be entitled to appoint one of the persons from the panel as the sole Arbitrator and communicate his name to the Appointing Authority.

If the Arbitrator so appointed is unable or unwilling to act or resigns his appointment or vacates his office due any reason whatsoever another sole Arbitrator shall be appointed as aforesaid.

The work under the contract shall, however, continue during the arbitration proceeding and no payment due or payable to the contractor shall be withheld on account of such proceedings.

The Arbitrator shall be deemed to have entered on the reference on the date he issues notice to both the parties fixing the date of the first hearing.

The Arbitrator may from time to time, with the consent of the parties, enlarge the time for making and published the award.

The Arbitrator shall give a separate award in respect of each dispute or difference referred to him. The Arbitrator shall decide each dispute in accordance with the terms of the contract and give a reasoned award. The venue of arbitration shall be such place as may be fixed by the arbitrator in his sole discretion.

The fees, if any, of the arbitrator shall, if required to be paid before the award is made and published, be paid half and half by each of the parties. The cost of the reference and of the award including the Fees, if any of the Arbitrator who may direct to and by whom and in what manner such costs or any part thereof shall be paid and may fix or settle the amount of costs to be so paid.

The award of the Arbitrator shall be final and binding on both the parties.

Subject to aforesaid, the Provisions of the Arbitration Act, 1996 or any statutory modification or re-enactment thereof and the rules made there-under, and for the time being in force, shall apply to the arbitration proceeding under this clause.

I / We hereby declare that I/We have read and understood the above conditions for the guidance of Tenderers.

Seal:
Place:

Signature of the Contractor
Address:

SPECIAL CONDITIONS OF CONTRACTS

1. All materials, tools, plants and equipment to be used for construction, shall be brought and stored on STOCK HOLDING premises by the Contractor in a manner directed in specifications for construction materials at his own cost and risk including his own security arrangement without causing hindrance to occupants.
2. All due precautions shall be taken by the Contractor to prevent damage including that of window panes, as a result of Contractor's action will have to be made good by the Contractor at his own expense.
3. a) All debris resulting from breaking work shall be carefully lowered on specially constructed platforms preferably in specially provided chutes and suitable screens and hoppers shall be provided to ensure that as far as possible no debris flies or rebounds from the building and / or scaffolding. Under no circumstances shall debris be thrown down on the ground or footpath.

b) The Contractor shall regularly remove all waste and debris from the site. Dumping of debris temporarily on the premises shall be strictly in location allotted for the purpose and nowhere else. Every day after working hour's sweepers must clean the site.
4. The Contractor will provide at his own expense necessary sheds, passages, special covering, platforms to be constructed in front of main entrance, STOCKHOLDING office, staff toilet, and also netting, kantans, etc. in area of common passage at the work site.
5. Proper cordoning off shall be maintained at all times to ensure that no children or unauthorized persons enter the work area.
6. The Contractor shall bear in mind that he may have to carry out certain part of work inside the premises of the occupants and he will take extreme care not to damage inside Branch.
7. The contractor shall provide at his own cost necessary sanitary and drinking water facilities for his workers more about in area of site only and they commit no nuisance.
8. When a contractor is selected, if Architect/ STOCKHOLDING find any anomaly in rates of some specific items, the Contractor shall furnish explanation and rate analysis.
9. Rates quoted by the Contractor shall include all terminal taxes, octroi duties, central or state excise duties, import duties, sales tax and any other taxes leviable under the state or central government or public rules. No claim whatsoever shall be entertained in respect of escalation in prices of materials, labour etc. except change in taxes announced by Municipal or Government bodies subsequently. Rates quoted also include work Contract Tax. M.W. Tax, extra water charges, all liaison work with Municipal Authorities for Building Department, Water Department, Pest Control etc. including specific bills of water charges and sewage charges raised by LOCAL AUTHORITIES towards the repair works under taken including all out-of-pocket expenses. The Contractor at his costs and expenses shall obtain all permission from LOCAL AUTHORITIES, etc.
10. The contract shall not be deemed to be duly completed until maintenance certificate have been issued by the Architect recording that the works have been completed and maintained to his satisfaction and will be issued after defect liability period is over and after ascertaining the views of the repair committee.
11. The Contractor is responsible for the execution of all works, which is more particularly set out as per terms and conditions of the Agreement. The Contractor is well aware about the dangers and hazards for the completion of the said work. It is the Contractor who would be responsible in the event of breakage of glass of windows, etc. of the STOCKHOLDING and Contractor will take all precaution of STOCKHOLDING's property so as not to damage them.
12. The Contractor, shall, at his own expense supply all the stores and materials required for the contract. All the materials to be supplied by the Contractor shall be of the best of kinds, and only of ISI standard. The Contractor shall furnish necessary proof to the satisfaction of the Architect / STOCKHOLDING that the materials complies with specifications as described in the Technical specifications. The Contractor shall, at his own expense and without delay, supply samples of materials proposed to be used in the execution of the work for the approval of the Architect / STOCKHOLDING, who may reject all materials not corresponding either in quality or in character with the approved samples. The Contractor is made aware that there will be no basic rate for all construction materials.

13. The Contractor shall not enter on or take possession of the site unless permitted to do so by the STOCKHOLDING. The portion of the site to be occupied by the Contractor will be clearly defined and indicated by the Stock Holding and the Contractor will on no account be allowed to extend his operation beyond these areas. Then on completion, completely clean the areas of works against his final completion of work done in that area.
14. The Contractor shall suspend the execution of the work of any part/s thereof, wherever called upon in writing by the STOCKHOLDING / Architect to do so and shall not resume work thereon until so directed in writing by the authority. The Contractor shall also suspend the execution of work or any part thereof under notice of court, Government or Municipal Corporation unless the Architect STOCKHOLDING instructs otherwise in writing. The Contractor will be allowed an extension of time for completion equal to period of suspension and no claim otherwise will be considered for payment. Time may also be extended to allow for alterations of work or deviation from the contract if it is felt reasonable by Architect / STOCKHOLDING.
15. If STOCKHOLDING has permitted the contractor to house his workers on site in specified areas, during progress of work he will erect temporary structures of the approved standards and scales for his workers and maintain at his own expenses. The Contractor should demolish / remove temporary structures before the main work comes to an end and clear the site. This facility is not incorporated in contract and will be exclusively at the discretion of the STOCKHOLDING and the STOCKHOLDING can stop this facility in the middle of work and Contractor cannot claim anything whatsoever for taking away this facility any time. If this facility is granted, he shall be responsible for giving all necessary notices of infection and contagious disease of his workers and instantly remove such cases from site. The Contractor shall obtain all necessary permission from municipality, government, etc. at his own costs.
16. It is hereby clarified that within the guarantee period of the entire work the owner / STOCKHOLDING observes any hitches or lacunas or damage caused to the flat and / or common area and / or the STOCKHOLDING's property, the Architect / Contractor shall be communicated regarding the same. The Architect / STOCKHOLDING would visit the premises and give their comments in respect of the same. The rectification of the damaged area is the sole prerogative and responsibility of the Contractor who is to rectify the said damage at his costs, etc. within the decided time frame as mutually decided between the parties. In the event of failure of the Contractor to rectify such error the STOCKHOLDING / Owner shall have the full liberty to deduct the amount of loss at cost from the balance amount due and payable to the Contractor.
17. The Contractor shall clean and level up the premises and open spaces in and around building to the satisfaction of the Stock Holding at regular intervals and after completion of work. If he fails to their satisfaction, the same shall be carried out by the owner at Contractor's risk, cost and consequences and work will be treated as incomplete.
18. It is hereby clarified that the Employees / Workers who would be assigned the work and who would be temporarily lodged in the premises of the owner shall have no access whatsoever in the building after the completion of the work for the particular days. The workers shall not enter the building for the purpose of taking water or for any other private jobs that would be given by the flat owners during the subsistence of the work assigned.

LIST OF APPROVED MANUFACTURES / SUPPLIERS OF MATERIALS

Company/ Client :-	Stock Holding Corporation of India Ltd.	
Address :-	Shop No. 202, 2nd Floor, Iconic Shyamal, Satellite, Ahmedabad	
Drawing Ref. Number :-	ALTERNATIVE NO. 4A	
Nature Of Work:-	Furnishing Work	
Material Specification For STOCK HOLDING, Ahmedabad Branch Office		
Sr. No.	Name of Item	Name of Brands
1	Gypsum board False ceiling	Would be use of MODI GUARD /SAINT GOBAIN or approved equivalent make.
2	Plywood	Would be use of Termite Proof MR grade plywood of ARCHIDPLY/ KAMA PLY/ FALCON PLY or approved equivalent make
3	Laminate	Would be use of SUNMICA PW - 15 MUSEAM OAK / G - 568-1568 ELECTRIC BLUE/ Greenlam
4	Glass	Would be use of MODI GUARD /SAINT GOBAIN or approved equivalent make. (With toughened treatment as and where required.)
5	Emulsion paint	Would be use of ROYAL ASIAN PAINT CREAM PIE- L152 (False Ceiling), SOFT HONEY – 7876 (Wall Paint), BING BLUE - 9205 (Wall paint behind seating) or NEROLAC / DULUX / BERGER. (Wall paint behind seating).
6	Lights	Would be use of CROMPTON/HAVELLS/PANASONIC (Pure white) or approved equivalent make.
7	Socket	Would be use of ANCHOR WOODS/ CRABTREE/ ABB or approved equivalent make.
8	Switch	Would be use of ANCHOR WOODS /CRABTREE/ ABB or approved equivalent make.
9	Wire	Would be use of Copper conductor PVC Insulated FRLS Wire Finolex, R.R Cable /Polycab Or Approved Equivalent Make.
10	PVC Pipe	Would be use of ISI MARK.
11	Flexible Pipe	Would be use of ISI MARK.
12	Modular Plate	Would be use of ANCHOR WOODS/ ABB / CRABTREE or approved equivalent make.
13	DB	Would be use of LEGRAND, L&T or approved equivalent make.
14	ELCB 63	Would be use of LEGRAND, L&T or approved equivalent make.
15	CCTV Camera	Would be use of HIKVISION or approved equivalent make.
16	Water Cooler Cum Dispenser	Would be use of BLUE STAR or approved equivalent make.
17	Wall Clock	Would be use of AJANTA or approved equivalent make.
18	Telephone Tag Blocks	Would be use of KRONE or approved equivalent make.
19	Air Condition	Would be use of Mitsubishi/Daikin/Voltas/Hitachi or approved equivalent make.

1. All materials to be delivered at site. If the material used for the work is not in conformity with the specifications, the same shall be replaced by contractor. All the material required for the above work shall be arranged by the contractor at his own cost.
2. Plywood mentioned in the drawings as well as in bill of quantities should be MR Grade only.
3. Selection of material to be done in consultation with the STOCKHOLDING 's representative / Architect.
4. All materials shall be of the first quality.
5. Wherever Contractor proposes to use 'equivalent 'makes (i.e., other than specified) the same shall be done only after prior approval from STOCKHOLDING. STOCKHOLDING may consult Architect before giving approval. Any additional expenditure, time due to this will be on Contractor's account and no claims will be entertained.
6. Read "or equivalent approved "at the end of the list of approved manufacture / sub-contractor / brand for every material.

PREAMBLE TO BOQ

Abbreviations:

R.M.T.	:	Running Meter
Sq. MT.	:	Square Meter
Sq. Ft.	:	Square Foot
Cu. Mt.	:	Cubic Meter
T.W.	:	Teak Wood
Q.R.O	:	Quote Rate Only
C / C	:	Centre to Centre
M.T.	:	Metric Ton
C.P.	:	Chrome Plated
NO.	:	Numbers.
MM.	:	Millimeter

1. All dimensions are in M.K.S. unless otherwise stated.
2. The quoted rate shall be all inclusive and cover the cost of material including wastage, Freight, all types of taxes, duties, royalties, erection, construction, testing of materials, if required samples brought for approval, tools and tackles, plant and equipment's, supervision, overheads, profit and any other expenditure incurred for completion of work as per drawings, specifications and to the full satisfaction of STOCKHOLDING / Architect.
3. The rates quoted shall be valid for working at all heights, depths, and on all floor levels, No extra payment shall be made for scaffolding, staging, ladders etc. for transportation of men and materials at higher or lower levels.
4. The item rate specifications are indicative. The Contractor will have to carry out the work In accordance with the drawings, technical specifications and / or other conditions laid down in tender document and to the full satisfaction of STOCKHOLDING / Architect.
5. Quantities mentioned against respective items are approximate and can vary to any extent. Payment shall be made on actually executed quantities.
6. No claims shall be entertained in case of increase or decrease in quantities, STOCKHOLDING / Architect reserve the right to increase / decrease quantities of any item and also to add / Delete any item in totality. STOCKHOLDING / Architect reserve right of operating any item for any work.
7. Rates for painting shall include cleaning glass panels, floor etc.
8. After completion of work the site shall be handed over absolutely clean, after ensuring that all floors, walls, etc. are spotless clean.
9. Rates of all items shall remain constant irrespective of floor level and no extra shall be Paid for handling and stacking of materials, removing debris etc. from the site.
10. Unless otherwise noted, the method of measurement will be as per I.S. 1200.
11. Stock Holding / Architect reserve the right of operating all 'Quote Rate only' items.
12. Wherever contractor proposes to use 'equivalent' makes (i.e. other than specified) he shall obtain Stock Holding's prior approval. Stock Holding may ask Architect before giving approval to the same. Any additional cost and time lost due to this will be on Contractor's account and no claims will be entertained.
13. The rate for partition, paneling shall include necessary additional framework supports that may be required to suit site conditions or stability of the item. Decision of Architect in regards to the need for such additional supports shall be final.
14. All wooden frame work / member size mentioned as out of, shall be full size with maximum planning tolerance of 3 mm both ways.
15. Rates for doors include all brass oxidized heavy duty hardware, locks, floor springs, door springs, door closer, special door handles etc. as specified in relative items.
16. Size and type of door closer / floor spring shall be suitable for type of door. The Contractor shall give guarantee for performance of door closer / floor spring from manufacturer.
17. Rates for partitions, paneling shall include making of necessary cut outs, chasing to be made for conduits, switch boards etc.
18. Rates for painting and polishing shall include cleaning glass panels, fans, floor etc.
19. After completion of work the site shall be handed over absolutely clean, after ensuring that all laminates, floors, walls, etc. are spotless clean.
20. Contractor shall clean the site and mark the lining out on the floor with adhesive tape for approval. The same shall not be paid separately.
21. In case of loose furniture, the specification for side unit or rear side credenza unit in any Item shall be same as the specification of the table in that item.
22. All key holes should be fixed with metallic key hole ring.
23. Key for all locks should be different and no key should match with two different locks.

Company/ Client :-	Stock Holding Corporation of India Ltd.
Address :-	Shop No. 202, 2nd Floor, Iconic Shyamal, Satellite, Ahmedabad
Drawing Ref. Number :-	Alternative No. 4A
Nature Of Work :-	Furnishing Work
	Date :- 29.05.2024

Sr. No.	Item Description/Particulars	Unit	Qty	Rate	Amt.
A	GENERAL WORKS				
1	Gypsum Board False Ceiling				
	Providing and fixing 12.00mm thick PVC laminated gypsum tile ceiling and fixing flat tee grid ceiling at all heights and levels Armstrong/ Saint-Gobain false ceiling systems, fine fissured ceiling tiles fixed to coordinated suspension ceiling system with galvanized steel sections (powder/ coil coated in white colour) of the grid consisting of hangers, main runners crossstess, perimeter profiles etc. all complete.	Sq.ft	1300		
2	Modular False ceiling (Grid Ceiling)				
	Providing and fixing 12.5mm thick gypboard ceiling surfaces in plain including G.I. suspenders forming a grid of intermediate channel at 1220mm centre to centre with ceiling sections fixed at 450mm centre to centre at right angle to the underside of intermediate channels with connecting clips complete as per India Gypsum Technical Manual including finishing with jointing compound and joint paper tapes and priming with two coats of drywall top coat and fixing of perimeter channel at both ends.	Sq.ft	400		
B	PAINT ON WALLS & CEILINGS				
1	Paint On Wall				
	Providing and applying painting with Two or more coats of acrylic emulsion paint of approved shade and colour of ICI/ Asian Paints/equivalent make to Wall any other exposed surface, applied evenly to give a approved uniform matt finish including preparation of the surface and primer coat etc. complete. Rate to include all necessary labour, material, hardware necessary for application, ladder, scaffolding etc. as necessary to complete the job. This item also includes some portion of the wall to be highlighted of different color shde as per requirements.	Sq.ft	2200		
2	Paint On gypsum Ceiling				
	Providing and applying painting with Two or more coats of acrylic emulsion paint of approved shade and colour of ICI/ Asian Paints/equivalent make to Ceiling any other exposed surface, applied evenly to give a approved uniform matt finish including preparation of the surface and primer coat etc. complete. Rate to include all necessary labour, material, hardware necessary for application, ladder, scaffolding etc. as necessary to complete the job.	Sq.ft	1300		
3	Synthetic Enamel Paint (for Rolling shutter)				
	Providing and applying synthetic enamel paint on rolling shutter including painting of STOCK HOLDING logo on rolling in standardised colour codes in required visible fonts with official business hours mentioned at particular location complete. Rate to include all necessary for application, ladder, scraffholding necessary etc. necessary to complete the job.	Sq.ft	500		
C	PARTITIONS & PANELLING				
1	Full/Low Height Partially Glazed And Partially Panelled Partition				

	Providing and fixing partially glazed partition including door up to 2'-9" height bottom 12 mm termite proof ply wooden partition both side having 1 mm thk. laminate of approved shade with up to 4'-3" height 12mm thk. float glass partition and top 2'-2" height termite proof wooden partition both side having 1mm thk. laminate of approved shade with top 0'-1" X 0'-1½" wooden frame as per the given drawings including all hardware in full respect. Rate to include all requisite hardware & finishing & fixing materials, transport labour etc. as necessary to finish the job all complete. This item also includes in low ht. partitions provision for planter box size 6" x 6" at the top of partitions.	Sq.ft	700		
	Full ht. glazed partition for cabins including doors				
	Size = 15'-0" x 10'-10" = 162.45 (Front of Broking Cabin)				
	Size = 18'-0" x 10'-10" = 194.94 (Front of Meeting and BM Room)				
	Size = 12'-0" x 10'-10" = 130 (between broking & Meeting Cabin)				
	Size = 8'-0" x 10'-10" = 87 (Side of BM)				
	Size = 8'-0" x 5'-0" = 40 (Central partition between BM & meeting room)				
	Size = 14'-0" x 5'-0" = 70 (UPS space)				
2	Full Height Solid Wooden Partition				
	Providing and fixing full height 12 mm thk. termite proof plywood solid wooden partition 3" thick on both faces and having 1 mm thk. laminate of approved shade make fixed on both surfaces and top 2'-2" height termite proof wooden partition both side having 1mm thk. laminate of approved shade with top 0'-1" X 0'-1½" aluminium frame as per the given drawings including all hardware in full respect. All exposed wood should be melamine finish as per approved tone by Architect in charge. Rate to include all requisite hardware & finishing & fixing materials, transport labour etc. as necessary to finish the job all complete.	Sq.ft	550		
	Size = 12'-0" x 10'-10" = 129.96 (Side of Brooking Cabin)				
	Size = 38'-6" x 10'-10" = 416.95 (Front & Side of Document room)				
3	Fully Glazed Full Height Partition with Wooden Box Framing				
	Providing and fixing 12mm thk fully glazed full height glass partition 3" thick with 6" X 3" framing with 12mm thk. termite proof Plywood on both faces and having 1mm thk. Laminate approved shade and make fixed on both face as per design drawings and including all fixing hardware all complete. Rate to include all requisite hardware & finishing & fixing materials, transport labour etc. as necessary to finish the job all complete.	Sq.ft	100		
4	Laminate Paneling (On Column)				
	Providing & fixing laminate paneling on RCC column/wall and existing wooden solid partition etc. to be made out of 1" x 1" aluminum framing for leveling at 2'-0" c/c in both ways with 12mm & 6mm thick MR Grade UF plywood of approved make. Paneling will be finished 1mm thick laminate of approved color & shade. If necessary 2" X 2" decorative beading/moulding will be provided at top & bottom or as per instructions with liquor polished. The entire item will be carried out as per direction.	Sq.ft	200		
D	DOORS				
1	Fully Glazed Toughened Glass Door				
	Providing and fixing 12 mm thk fully glazed toughened glass openable door shutter with patch fittings to take floor spring, handle, lock including 6" X 2" termite proof ply wooden framing & fitting etc. All necessary equipment & labour necessary to complete the job. melamine polish for the wood frame. Rate to include all requisite hardware & finishing & fixing materials, transport labour etc. as necessary to finish the job all complete.	Sq.ft	0		
2	Laminated Flush Door				
	Providing and fixing 1mm thk. Laminate of approved shade on existing flush door with all necessary fixing hardware complete.	Sq.ft	20		

	Size = 1 x 2'- 9" x 7'-0" (near pantry)				
E	LOOSE FURNITURE				
1	User Counter Work Station				
	Providing and Fixing linear / running Work Station having a size of 16'-0" x 2'-6"x 2'-6" in 25mm thk. termite proof ply of approval make for table top & side supports. The Front side of table in 12mm. Thk. termite proof ply with approved colour 1mm thk Laminate & on fixed Raised panel in 12mm. Thk. Finished in approved colour laminate for all exposed surface, fixed with S.S. Stude & the top and sides of the counter to be finished on both sides with 1mm thk. Laminate of approved make and shade / design. A Powder coated Wire manager, Key board made out by wooden support and channel, Drawer size 16" x 24" x 24" deep made out of 12 mm thk. Ply, wooden beading patty four side in laminate finish run on with heavy duty sliding Chanel, A drawer unit of size 1'-4" x 0'-5" x 1'-10" in 19 mm termite proof ply with two drawers and unit of size 1'-4" X1'-4" X 1'-10" openable shutter with auto hinges, handles, lock etc. to be provided in standards make as per the drawing etc. complete. Rate shall be inclusive of providing and fixing 12mm thk. Front glass 1'-0" ht. 6" gap on table top for work station with diamond edge polish with S.S. "D" brackets. The entire item will be done as per requirement and design pattern given as per directed.	No.	1		
	Size - 16'-0" x 2'-6"x 2'-6" (Work Station)				
2	Broking Cabin - Modular Work station				
	Providing and Fixing linear / running Work Station having a size of 12'-0" x 2'-6"x 2'-6" ht. in 25mm thk. termite proof ply of approval make for table top & side supports. The Front apron in 12mm. Thk. termite proof ply with approved colour 1mm thk. Laminate & on fixed Raised panel in 12mm Thk. Finished in approved colour laminate for all exposed surface, fixed with S.S. Stud & the top and sides of the counter to be finished on both sides with 1mm thk. Laminate of approved make and shade / design. A Powder coated Wire manager, Key board made out by wooden support and channel, Drawer size 16" x 24" x 24" deep made out of 12 mm thk. Ply, wooden beading patty four side in laminate finish run on with heavy duty sliding Chanel, A drawer unit of size 1'-4" x 0'-5" x 1'-10" in 19 mm termite proof ply with two drawers and unit of size 1'-4" X1'-4" X 1'-10" openable shutter with auto hinges, handles, lock etc. to be provided in standards make as per the drawing etc. complete. Rate to include all requisite hardware & finishing & fixing materials, transport, labour etc. as necessary to finish the job all complete. The entire item will be done as per requirement and design pattern given as per directed.	No.	1		
	Size = 12'-0"X 2'-6" X 2'-6"				
3	Wooden Tables				
	Providing and Fixing Wooden Tables having required size in 25 mm thk. termite proof of approved make for table top and sides. Table Front side made out of 12mm. Thk. termite proof ply with approved colour laminate & on additional raised panel 12mm thk. termite proof ply with approved colour laminate fixed with S.S.Studs for Table front apron. A Powder coated Wire manager, Key board made out by wooden support and channel, drawer size 16" x 24" x 24" deep made out of 12 mm thk.. Ply, Wooden Beading patty four side in Laminate finish run on with Heavy duty sliding Chanel the side credenza of size 3'-0" x 1'-3" x 2'-6" ht. in 19 mm termite proof ply with two drawers size 1'-4"x 0'-5"x 1'-3" & two openable shutters size 1'-4"x 1'-8"x 1'-3" with bottom 3" base in 18 mm termite proof ply with as per the drawing, finishing in 1 mm thk.. Laminate of approved make and shade / design etc. Rate to include all requisite hardware & finishing & fixing materials, transport, labour etc. as necessary to finish the job all complete. The entire item will be done as per requirement and design pattern given as per directed.				

	BM Table Size = 5' -0" x 2' - 6" x 2' - 6" with Side Cabinate - 3'-6" x 1'-4" x 2'-6"	No.	1		
	Meeting Room Table Size = 5' -6" x 2' - 6" x 2' - 6"	No.	1		
	Reception & clerk Table Size = 3' -0" x 1' - 9" x 2' - 6"	No.	3		
4	Low Ht. Floor Mounted Storage Unit				
	Providing and fixing a floor mounted storage unit size 5'-3"X 1'-6"X 2'-0" in 18mm thk. termite proof plywood with 8 mm thk. plywood back and 18 mm thk. shelf in entire length of wall mounted storage and having 18 mm thk.. Plywood shutter and with 1 mm thk. laminate of approved shade With 3"thk. 6" width palement bottom make on wall external surface and 0.6 mm thk. liner laminate of approved shade and make on all internal surfaces with all locks, handles and hardware necessary for fitting all complete. All edges to have 2mm thick teak beading with polish, binding to match external laminate. Rate to include all necessary fitting & fixing hardware etc. complete.	Sq.ft	125		
	Size = 20'-0" X 2'-6" X 1'-6" (front office rear Storage)				
	Size = 7'-6" X 2'-6" X 1'-6" (BM Rear Storage)				
	Size = 7'-0" X 2'-6" X 1'-6" (meeting room Rear Storage)				
	Size = 15'-0" X 2'-6" X 1'-6" (Brooking Office rear Storage)				
5	Over Head Storage Unit in wall				
	Providing and fixing Built in storage made out of 19mm thk. termite proof Ply 45cm deep, 6mm thk. termite proof Ply for the back, Openable shutters with hinges as recommended & in laminate of approved colour. 19mm removable shelves with laminate finish on both sides edges shall be provided with leaping patties on all sides, at 40 cm spacing. All hinges, tower bolts, S.S. brush finish handles, ball-catches shall be of brass heavy duty. Complete with approved make Locks handles etc. complete as per design/instructions. All the shutters shall be made out of 12 mm termite proof ply framing 80 mm wide with 3 Nos. wide at middle horizontal and 2 vertical rails and then covered with 6 mm termite proof ply from both sides with internal surface with liner laminate on both sides of the shutter, All Internal & External Surface finished with approved colour laminate. Rate to include all requisite hardware & finishing & fixing materials, transport, labour etc. as necessary to finish the job all complete.	Sq.ft	125		
	Size = 20'-0" X 2'-0" X 1'-6" (front office rear Storage)				
	Size = 7'-6" X 2'-0" X 1'-6" (BM Rear Storage)				
	Size = 7'-0" X 2'-0" X 1'-6" (meeting room Rear Storage)				
	Size = 15'-0" X 2'-0" X 1'-6" (Brooking Office rear Storage)				
	Size = 12'-0" X 2'-0" X 1'-6" (above dining counter Storage)				
6	Full Height Storage Unit on floor				
	Providing and fixing full height storage units consist of 18mm thk. Termite proof ply top, sides, bottom, shelves and shutters with 1mm thk. laminate. The back of the storage shall consists of 18 mm termite proof ply .The bottom of the storage shall be at 75 mm from FFL. The shutter with box type hinges and openable shutter finished with approved shade 1mm thk. laminate on all the shutter edges. Division of the shutters shall be made equally according to the length of the storages. internal surface with liner laminate. All edges to have 2mm thick teak beading with polish. binding to match external laminate include all necessary fitting & fixing hardware etc. all complete.	Sq.ft	50		
7	Dinning Counter/Lunch Desk at Lunch room space				
	Providing and fixing Dinning counter/Lunch Desk in size 5'-3" length & 1'-6" width made out from 36 mm thk. (18mm double sandwich type) termite proof plywood with 1 mm thk. Laminate of approved shade and make on all external surfaces and 0.6mm thk. liner laminate of approved shade. The counter/desk will have required suppot/bracket made from plywood & laminate finish etc. complete. All edges to have teak beading with polish. binding to match external laminate include all necessary fitting 7 fixing etc. all complete as per direction .	Sq.ft	20		
	Size- 12'-0" X 1'-6" (3'-0" height from the floor level at Lunch room)				
8	Magazine Rack				

	Providing and fixing magazine/Display rack with size 3'-0" X 0'-6" X 7'-0" and 6" deep in 18 mm thk. termite proof ply with 6 mm thk. Plywood back and 12mm thk. Glass shelves in inclined angle to store with 1 mm thk. laminate of approved shade and make on all external surface and 0.8mm thk. liner laminate of approved shade and make on all internal surface with hardware necessary for fitting all complete as per drawing. All edges to have TW edges bend to match with external laminate. Rate to include all necessary fittings and fixing hardware etc. all complete.	Sq.ft	20		
9	Company Logo On Glass				
	Providing & fixing STOCK HOLDING Logo as per standardized design with 8 mm thk. clear glass & size of 2' x 2' & back colour stickers with SS stud as per design etc. Complete.	Sq.ft	4		
10	Privacy Film -One way-vision film				
	Providing & fixing one way vision digital print with STOCK HOLDING Logo colour scheme on main Glass door shutter and fixed glass partition complete including finishing and jointing .drawings and architects instruction. Rate to include material labour, cutting fixing transport etc. all complete . Contractor shall provide digital draft copy of design for STOCK HOLDING for approval before printing and installation.	Sq.ft	150		
11	Display Board/ Soft Board/ Notice Board				
	Providing and fixing of 12mm thk. Soft board with 12mm thk. termite proof Plywood back side and with 12mm thk. Boarder Patti on all 4 sides and covered with fabric of approved make and shade and fixed to wall all complete. All boarder Patti to be finish in lacquer polish with melamine finish in approval shade. The shade of fabric shall be as per company stander colour scheme.	Sq.ft	150		
12	Backlit Glow Sign Board				
	Providing and fixing GI. Metal box framed backlit type acrylic with digital print surface glow sign board as per company's standardized colour scheme including electrical connections and fitting with required scaffolding /ladder as per site condition. Rate to also include shifting and necessary fitting & connection of ON/OFF timer. (This item also includes desing as per STOCK HOLDING 2022 Specifications)	No.	1		
	Size- 16'-0" X 2'-6" (Out Side)				
13	Networking Equipment 12 U or 16 U Router Box				
	Providing and fixing 12U OR 16U Wall Mounted Rack with Size Width 1.65 Feet Height Feet x 1.65 Inch x Defth 1.65 Feet, with Accessories, Fully Loaded (exhaust fan, PDU 6 point-5 amp, 4 nos of shelves full size, 2 cable managers, with door and hardware) complete including making incoming holes for wire , cable etc. Rate to include all necessary material, hardware, finishes transportation and installation etc. all complete.	No.	1		
14	High Back Chair - Godrej Interio make				
	Providing and fixing godrej beat blue colour fabric high back chair having size 67.5 CM (W)X 67.5 CM(W) X 102-119 CM (H) MS frame covered with breathable mesh for back & Lumber support, 12mm.Moulded ply for seat with PU on it. PU Adjustable arms, Chrome base, Synchro mech. & gas Lift etc. complete. Or as per manufacturer specification includes necessary material, hardware, finishes transportation & installation etc. all complete	No.	1		
15	Staff Chairs - Medium Back Chair - Godrej Interio make				
	Providing and fixing godrej beat blue colour fabric medium back chair having size 67.5 CM (W)X 67.5 CM(W) X 92-110 CM (H) in MS frame covered with breathable mesh for back & Lumber support, 12mm.Moulded ply for seat with PU on it. PU Adjustable arms, Chrome base, Synchro mech. & gas Lift etc. complete. Or as per manufacturer specification includes necessary material, hardware, finishes transportation & installation etc. all complete	Nos.	10		
16	Visitor's Chair - Low Back Chair - Godrej Interio make				
	Providing & fixing godrej beat blue colour fabric visitor's low back chairs having size 57.5 CM (W)X 58.2 CM(W) X 100.8 CM (H) covered as per manufacturer specification includes necessary material, hardware, finishes transportation & installation etc. all complete	Nos.	13		

16A	Meeting room Chair - Low Back Chair - Godrej Interio make				
	Providing & fixing godrej make Meeting Room covered as per manufacturer specification includes necessary material, hardware, finishes transportation & installation etc. all complete	Nos.	8		
16B	Lunch Room Chair				
	Providing & fixing godrej make pantry room covered as per manufacturer specification includes necessary material, hardware, finishes transportation & installation etc. all complete	Nos.	5		
17	TEPOY/CENTER TABLE				
	Providing & supplying Tepoy/Center tables size 2'-0" x 3'-0" to be made out of 18mm plywood boxing finished with with 1mm thick laminate finish. 12mm thick glass top fixed on support with rubber gasket and ss stud air vacuum etc. complete	Nos	2		
18	VISITOR SOFA				
	Preparing and providing fully upholstered sofa made of teakwood frame work of 3"x1½" size for the structure, seat and back. The box be made of 19mm thick plywood of MR grade UF Plywood of approved make and back rest and the rear to have 6mm thick plywood of MR grade UF Plywood of approved make. The seat shall have helical coil springs covered with jute cloth fixed to the frame work of seat. The seat shall be provided 3" thick foam rubber for seat 2" for back and extra ½" for edge binding. The entire sofa along with seat back & handles shall be lined with tapestry finish of approved make, colour, shade and design with necessary piping, stitching etc. complete with stainless steel studs and shoes. All the exposed wooden surface shall be lequare polished. (Basic soct of tapestry fabric @ 300/- per Meter.). For RM/WAITING only. - 7 RFT X 2 Nos.)	Rft.	14		
19	ELECTRICAL PANEL BOARD CUP BOARD				
	Supplying, providing & fixing Electric cup board shutter made out from 19mm thick plywood of MR grade UF Plywood of Kama Ply/Falcon Ply/Virgo Croma make with 1.0mm thick laminate of approved make on outer sides, polishing/painting on internal surface side Goderj lock, handle ball catchers, SS jail, complete as directed depth of cup board is as per requirement etc. as per instructions. The entire inner surface of cup board shutter will have 0.8mm thick balance laminate as per instruction.	Sq.ft	25		
	Size- 3'-0" Length X 8'-0" Height X 16" Width/Deep (Out Side)				
F	ELECTRICAL WORKS				
1	5 AMP Plug Point :(1 Nos pp / 1 Nos S/W)				
	Supply, installation testing & commissioning of 1 Nos 5 amp 3-pin plug point powered by 1 Nos 5 Amp switch, mounted on switch board, and having FRLS wiring in single core multistring /flexible 1.5 sq.mm. PVC insulated copper FRLS wire, installed in concealed rigid 2mm thk. PVC conduit of 25 mm dia.& including earth wire of proper capacity & including switch board, concealed box, plates etc. as required all complete. Point to be considered at point rate only. A Maximum of Three Nos plug point will be taken on one circuit. (AEC power for all Plug Points)	Nos.	15		
2	5 AMP Plug Point: (2 Nos pp / 1 Nos S/W)				
	Supply, installation testing & commissioning of 2 Nos 5 amp 3-pin plug point powered by 1 Nos 5 Amp switch, mounted on switch board, and having FRLS wiring in single core multistring /flexible 1.5 sq.mm. PVC insulated copper FRLS wire, installed in concealed rigid 2mm thk. PVC conduit of 25 mm dia. & including earth wire of proper capacity & including switch board, concealed box, plates etc. as required all complete. Point to be considered at point rate only. A Maximum of Three Nos plug point will be taken on one circuit. (UPS Power for only UPS Points) Location at Computer 4x4 rectangle box, switch Board required Total nos 70 (FO 16 point / Broking 20 Point / BM 8 Point / 10 Network Rack / 2 Burgler alarm	Nos.	60		

3	15 AMP Plug Point :				
	Supply, laying, installation & testing of 15 amp plug point wiring using 1100 v grade 3 nos of 2.5 sqmm Copper conductor PVC insulated FRLS wires (with Proper RYB colour code) pulled through rigid /flexible 25mm /20mm PVC conduits of medium quality & crimp type lugs at both ends. Each circuit feeding not more than 4 points.(For UPS /Battery area). This item also includes required MCB for Input & Out for UPS power etc. complete as per direction.	Nos.	10		
4	Air Condition Point				
	Supply, installation, testing & commissioning of 15 amp 3-pin plug point done with 2 nos of 4 sq. mm flexible Copper conductor PVC wire with stranded Cu. earth wire or 2.5 sq. mm. insulated earth wire mounted on switch board. and having specs. This all the points as per site condition and requirements.	Nos.	5		
5	Wall Fan Point				
	Supply, installation, testing & commissioning wall fan points comprising of 5amp socket near fan and switch on light switch board or wall fan.	Nos.	7		
6	Ceiling Fan Point				
	Supply, installation, testing & commissioning ceiling fan points comprising of 5amp socket, regulator near switch on light switch board for ceiling fan.	Nos.	5		
7	Exhaust Fan Point				
	Supply, installation, testing & commissioning Exhaust fan points comprising of 5amp socket near fan and switch on light switch board exhaust fan. One point behind branch manager partition & One point in Toilet ventilation.	Nos.	2		
8	25 MM Dia Mark PVC Heavy Duty Conduits				
	Supply and laying of following RACEWAYS/CONDUITS in required size trenches with proper ties / clamps at appropriate intervals. The rate shall be inclusive of carefully removing the floor tiles by machine cutting &removing the malwa below the tiles for laying raceways conduits for power, telephone, Data cables etc. The depth of the trenches shall be minimum 2" or upto the RCC of slab from the finished floor level . The rate shall also inclusive of back filling the trenches with mix of 1:2 PCC after laying the raceways /conduits for smooth finish upto the floor level.	Nos.	10		
9	Armoured Cable				
	Supply & Installation 25 mm armoured cable having sector / circular shaped aluminium / copper conductor PVC insulated cores, laid up, PVC tape wrapped inner sheathed, GI strip / wire armoured and overall extruded PVC sheathed conforming to IS: 1554, laid on wall / ceiling using GI clamps & spacers as per route shown at site (Use for Main 3 phase Electric line from Distribution Board in Server Room)	Mtr	30		
10	Circuit Wiring For 5 Amp Plug/ Switch				
	Supply, installation testing & commissioning of 2.5 sq. mm flexible Copper conductor PVC wire with stranded Cu 1.5 sq. mm. insulated earth wire from D.B. to PLUG POINT. Maximum of 3 Nos plug points to be taken on each circuit.	Mtr	250		
11	Circuit Wiring For 15 Amp Plug/ Switch				
	Supply, installation testing & commissioning of 4 sq. mm flexible Copper conductor PVC wire with stranded Cu 2.5 sq. mm. insulated earth wire from D.B. to PLUG POINT	Mtr	200		
12	6.00 Sq.mm Wire For DB And Main Line				
	Supply, installation testing & commissioning of 6 sq. mm wire Copper conductor PVC wire with stranded Cu 2.5 sq. mm. insulated earth wire .	Mtr	50		
13	1.5 Sq.mm Wire				
	Supply, installation testing & commissioning of 1.5 sq. mm wire from main DB to Circuits.	Mtr	200		
14	1 Nos Light Point Single Switch Operated :				
	Supply, installation testing & commissioning of Light point connected from 1 nos switch to 1 nos light point with 1.5 sq. mm flexible Copper conductor PVC wire with stranded Cu 1.0 sq. mm. insulated earth wire from switchboard to light point. Maximum of 3 Nos light points to be taken on each circuit	Nos.	50		

15	2 Nos Light Point Single Switch Operated :				
	Supply, installation testing & commissioning of Light point connected from 1 nos switch to 2 nos light point with 1.5 sq. mm flexible Copper conductor PVC wire with stranded Cu 1.0 sq. mm. insulated earth wire from switchboard to light point. Maximum of 3 Nos light points to be taken on each circuit.	Nos.	20		
16	18 Walt Concealed LED Square Type Fixture				
	Providing and installing 18 Walt Square LED fixture(Pure white) as per sample including all necessary suspension system from main RCC slab and cut-out in False ceiling.	Nos.	40		
16A	36 Walt Concealed LED Square Type Fixture				
	Providing and installing 36 Walt Square LED fixture(Pure white) as per sample including all necessary suspension system from main RCC slab and cut-out in False ceiling.	Nos.	36		
17	20 Walt LED Tube Light Type Fixture				
	Providing and installing 20 Walt Tube Light LED fixture(Pure white) as per sample including all necessary fitting & fixtures on wall and ceiling as per requirements.	Nos.	3		
18	TPN Distribution Board (Lighting/A.C)				
	Supplying assembling installing testing of TPN Distribution board as required. All GEB and UPS power control by TPN distribution board. Rate to including all DPMCB & SPMCB as required. All MCB & Box to be of LEGRAND make.	No.	2		
19	TPN Distribution Board (Computer & UPS Power)				
	Supplying assembling installing testing of TPN Distribution board as required. UPS power control by TPN distribution board. Rate to incl. all DPMCB & SPMCB as required. All MCB & Box to be of LEGRAND make.	No.	2		
20	Main Electrical panel				
	Supplying, assembling, installing, testing of Main Electrical panel with bus bar, digital meter required capacity MCB, ELCB, Power switch etc. as per Requirement.	No.	1		
21a	ELCB 63 Amp :				
	Supplying, assembling, installing, testing of 63 Amp ELCB in Main Distribution Board	No.	1		
21B	Main Electrical Switch with Cabling				
	Supplying, assembling, installing, testing of Main Electrical Switch with Required size cabling Wire near entry to cut of electrical power off as per requirement.	No.	1		
22	Exhaust Fan				
	Providing and fixing Exhaust fan of 200 mm size self opening louvers system complete including making opening in existing wall or wooden partition. For toilet & ups of approved make like Crompton/Havells/Bajaj.	Nos.	2		
23	Ceiling Fan				
	Providing and fixing 1000 mm ceiling fan make havelles or equivalent of approved make like Crompton/Havells/Bajaj. This item also includes required anchor fastner etc. complete as per direction.	Nos .	5		
24	Wall Fan				
	Providing and fixing 450 mm dia. high flow wall mounted fan make havelles or equivalent of approved make like Crompton/Havells/Bajaj. This item also includes required base plate etc. complete as per direction.	Nos .	7		
25	Providing and laying RG-6 channel wire from outside of individual TV point as per requirement.	Mtr	50		
26	Providing and Installation of HDMI Cable as per requirement.	Mtr	50		
G	DATA & VOICE WORKS				
1	Computer Lan point :				
	Supplying & fixing necessary box, io plate, & jack type socket of D-LINK make and with all wiring duly connected. Location at Front Office - 10 Nos., Broking Office - 5 Nos., Meeting RM - 2 Nos., BM - 2 Nos.	Nos.	20		
2	Computer Lan wiring : (CAT-6)				

	Supplying, laying, drawing, testing & commissioning of D-LINK CAT-6 cable in concealed manner in rigid PVC heavy duty conduit pipe having a wall thickness of 1.5 to 1.8 mm & having min die of 20mm or 25 mm as required & specified. Pvc conduit pipe is to be concealed in chasing in wall or floor/ existing flooring after cutting the existing flooring finish & laying conduit pipes/raceways in proper line & level 1" below the bottom level of the proposed tile flooring and concealing the same in cement mortar 1:4. Mortar in smooth finish flush with top level of existing flooring; or concealed in Modular partition or gypsum partition or plywood partition in same manner as mentioned above or below carpet flooring. Rate to include all necessary chipping, cutting, chasing of plaster, brickwork, mortar, tile or RCC work & filling & finishing the same with cement mortar 1: 4 in proper line & level.	Mtr.	250		
3	Computer Lan Patch Code				
	Providing and fixing (2 ft. long) patch code - (D - Link)	Nos.	20		
3A	Patch Panel				
	Providing and fixing 24 Port patch panel (D - Link)	Nos.	1		
4	Telephone Point :				
	Supplying & fixing necessary box, plate, & RJ-11 jack type socket of approved make and with all wiring duly connected. (4 Port for each working table) .	Nos.	10		
5	Telephone Wiring : (CAT - 6)				
	Supplying, laying, drawing, testing & commissioning of D-LINK CAT-6 cable (Blue Or Yellow Colour) 5 in concealed manner in rigid PVC heavy duty conduit pipe having a wall thickness of 1.5 to 1.8 mm & having min die of 20mm or 25 mm as required & specified. Pvc conduit pipe is to be concealed in chasing in wall or floor/ existing flooring after cutting the existing flooring & laying conduit pipes/raceways in proper line & level 1" below the bottom level of the proposed tile flooring conduit pipes in proper line & level and concealing the same in cement mortar 1:4. Mortar in smooth finish flush with upper level of existing flooring. Rate to include all necessary chipping, cutting, chasing of plaster, brickwork, mortar, tile or RCC work & filling & finishing the same with cement mortar 1: 4 in proper line & level & clearing of the site & building of all debris etc. all compete .	Mtr.	100		
6	Telephone Tag Blocks				
	Supply and installation, testing & commissioning of 20 pair telephone tag block 10 patch code with KRONE terminal connectors, CAT - 6 Cable, M.S.J.B. connectors, as specified and located at site as per architects instructions. Rate to include all necessary fixing hardware etc.	No.	1		
7	Telephone Jack				
	Supply and installation of Telephone point wiring on workstations / tables/ partitions by using 2-pair cable pulled through already laid floor raceways/conduits and taken up to the table top using PVC rigid / flexible conduits run concealed. Each point consists of one RJ-11 jack type telephone socket, MS box flush to the surface, front plate etc. & hardware as required. Location at Manager - 1 Nos, Front Office - 4 Nos., Broking Office - 3 Nos. and For Barglar Alarm System - 1 No. (4 Port socket) .	Nos.	10		
8	Chemical Earthing using Electrode of size 80 mm dia, 2 meter long connected with 50X6 mm Copper internal strip complete with excavation, civil works, cast iron cover with back fill compound. The voltage between Neutral & Earth not to exceed 2 volts. including bore holes wherever required and putting the earth as per requirement.	Nos.	1		
9	Supply & Installing of copper /GI earthing wires/strips in following sizes				
	8 SWG copper bare wire	Mtr.	100		
H	CCTV SURVEILLANCE SYSTEM & BURGLAR ALARM				
1	New Supply & installation Dahua / Hikevison / CPPlus with IP Bass HD Night Vision IP Camera to Lan cable & NVR + switch with 1 TB Surevelance HDD / with Voice audio recording facilities as per the company manual with all cabing, accessories and DVR etc complete.	Nos.	10		

2	Providing and installing CAT - 6 Cable for camera.	Rmt.	200		
3	Providing & fixing burglar alarm system including center point - 5 nos, Panic Button - 2 nos., PIR - 3 nos., Hooter - 1 No. PSTN TELEPHONE AUTO CALLING FACILITY, SECURICO MAKE with necessary electrification and telephone point - 1 no. etc. complete as per requirement	Job	1		
4	Providing and installing CAT - 6 Cable for burglar alarm.	Mtr.	100		
I AIR CONDITION WORK					
1	Providing & fitting Hi-wall mounted type Casette & split Air-conditioner of Voltas/Carrier/Hitachi/Daiken/Blue Star/Mitsubishi (Heavy duty)/ With minimum 3 star rating including necessary jari work finished with plaster putty complete .				
2	3.0 TR Casette type AC (front office area)	No	1		
3	2.0 TR Casette type AC (manager/meeting, broking office & document room area)	No	4		
4	Removing & re-fixing of existing split A. C. indoor & outdoor unit, L shape stand, M. S. Stand etc. with servicing, repairing, gas filling etc. completed as per new lay out plan and old premises to new premises as per direction. (2.0 TR - 1 NO)	No	1		
5	Installation of cassette type a.c. unit	No	5		
6	Copper piping work (for both cassette and split)	Rft.	225		
7	Drain piping work (for both cassette and split)	Rft.	225		
8	Electrical cabling for Casette type a.c. unit	Rmt.	210		
J MISCELLANEOUS ITEMS					
1	Water Cooler Cum Dispenser				
	Providing and fixing water cooler cum dispenser (Hot & Cold type)with top loading type refill RO water bottle facility of Blue star, Kent or any other standard IS make complete .	No.	1		
2	Wall Clock				
	Providing and fixing wall clock of Ajanta or equivalent.	No.	3		
3	Floor Door Mate				
	Providing and fixing floor door mate.	Sq.ft	10		
	Size = 4'-0" X 2'-0"				
4	Fixing of existing miscellaneous items like T.V. unit, Set Top Box, Photo frame etc. at new location as per direction of STOCK HOLDING.	Job	1		
5	M. S. slotted Angle rack Storage				
	Providing and making Powder coated M.S. slotted angle storage using angles of 18 gauge thickness and shelves of 20 gauge designed as per the specifications of standard manufacturers. Shelves 4 nos. minimum shall be provided at 1'-6" c/c & supported on frames on all four sides with vertical supports as per manufacturers' standard specifications.	Sft	500		
6	Sliding/foldable rolling shutter				
	Providing and fixing sliding/foldable rolling shutter as per size and shape requirements. The above rolling shutter as per manufacturer's specifications. The entire item should be carried out as per requirement and direction of Architect.	Sft	185		
7	Pop up box for meeting room table				
	Providing and fixing required capacity pop up box as per requirement and direction of Architect.	No.	1		
8	Frosted film on glass				
	Providing and fixing required design frosted film on glass as per requirement and direction of Architect.	Sft	200		
9	Roller blinds				
	Providing & Fixing roller Blinds of Dustguard Classic range with 5mm high x 50mm and 100mm wide 1.2mm thick walls of alluminium alloy head rail with 3.5.1 planetary reduction gear box (end control unit) with plastic tilting	Sft	100		

	chain, tilt rod runners with firm and gear mechanism with 180 degree rotating louvers with approved shades by Architect/Consultant protected by dust guard. Fabric protector of NEON make with matching balance of same fabric on channel. The measurement shall be considered as per plan area of the window/ opening/partition only and measurements of Air conditioners will be deducted.				
10	Wooden Flap Door				
	Supplying & fixing wooden flap door shutter made out of 19mm thick plywood of MR grade UF Plywood of approved make with 1mm thick laminate of approved make on both sides with necessary periphery steam beech beading with laquore polish. Door will have required hinges, stopper, handle etc. complete as per direction of Architect.	Sft	20		
11	Window in document partition				
	Providng and fixing required design alluminium framed powder coated sliding/openable window with glass as per requirement and direction of Architect. (2' x 2')	No.	1		
12	Pantry platform				
	Providing and fixing granite top sandwich type manner with required vertical supports etc. for pantry platform. This item also include provision for water supply pipeline with accessories, drainage pipeline with accessories, S.S. Sink and sink cock etc. complete as per directions	Rft.	7		
13	Wooden Shutter for Pantry Platform				
	Supplying, providing & fixing pantry platform shutter with required framing etc. with shutter made out from 19mm thick plywood of MR grade Plywood of approved make with 1.0mm thick laminate of approved make on outer sides, polishing, internal surface of the shutter will be finished with 0.8mm thick liner balance laminate with side Goderj lock, handle ball catchers, complete as directed below pantry platform as per requirement and directions.	Sft	20		
14	Cleaning the site				
	After completion of entire work the premises/office will be cleaned as per requirement of STOCK HOLDING	Job	1		
15	Carbon-di- oxide type fire extinguisher of 4.5 kgs. Capacity, CO2 gas filled in brand new seamless cylinder with powder coated finish, made out of Manganese steel, with wheel type valve, discharge nozzle, bend & horn, wall mounting bracket etc. complete, confirming to IS: 15683.	no.s	3		
16	ABC powder type fire extinguisher of 6 Kgs. Capacity, with initial filling in brand new cylinder with powder coated finish, fitted with Gun metal union, Store Pressure, wall mounting bracket etc. complete, confirming to IS:15683.	no.s	3		

Sub Total

-

SGST 9%

-

CGST 9%

-

**Total
Amount**

-

Notes:

- 1 The giving all quantities are an approximate basis there will be a variation in quantity of few or all item as per site conditions/ changes in specification or finalisation of designed from client ends.
- 2 Location of switch board or camera etc. may change to the that given drawing as per client requirement drawing the execution process of the work.
- 3 The quantity of wire may change as per site condition and limitation to work due to final situation of the present site.
- 4 Any addition or omission to the work or any activity which is covered or not covered in the BOQ or drawing have to be bought under the consideration of architect before the execution.

TECHNICAL SPECIFICATIONS

CARPENTRY AND FINISHING WORK

Joinery in Timber: -

All joints shall be standard mortise and tenon, dowel, dovetail and cross halved. Screws, nails etc. will be of standard iron or wire of oxidized nettle fold, tenons should fit the mortises exactly. Where screws show on a finished surface, those will be sunk and the hole plugged with a wood plug of the same wood and grain of the finished surfaces will be neatly punched and hole filled with wood filler to match the color. The contact surface of dowel, tenons wedges etc. shall be glued with an approved adhesive.

Timber

All woods should be properly seasoned of natural growth and free from worm holes, loose or dead knots or other defects and shall not suffer warping, splitting or other defects. The moisture contents shall not exceed 12% All wood brought to site should be clean. All internal framework shall be treated with approved wood preservative.

Plywood

Plywood should be used after applying white anti termite liquid. Nails or screws fixed in the plywood should be equally spaced. The plywood sides wherever they are visible should be covered with the beading patti. Too many joints in furniture pieces will not be considered. Rough finished sides while fitting the fixtures like locks, hinges etc. will not be considered. The contractor will have to make punctures of cutouts as required by electrical or any other contractor, for which no separate payment will be made by the Stock Holding or by the respective contractor. All contractors will work in team of good spirit and in good faith. Certain details shall be modified as per the site adjustments.

Laminate

The laminate should be used to approved make and shade and of 1.5 mm thickness only. No scratches or patches on laminates shall be considered.

Hardware and Metals

The hardware throughout shall be of approved manufacturer. The fitting generally shall be of brass or oxidised brass unless otherwise specified. The screw should match the finish of the article to be fixed and to be round or flat headed or counter sunk as required.

Glass

All glasses should be of approved manufacturer and free from bubbles, smoke, air-holes and other such defects. While cutting glass, proper allowance be made for expansion. All cracked, scratched and broken pane should be replaced

TECHNICAL SPECIFICATION FOR ELECTRICAL WORK

POWER PANELS:

The Power panels shall be fabricated from MS sheet steel 16 gauge and shall be of compartmental design. The main supporting framework shall be of angle iron or of heavier gauge sheet metal. The panel shall be self-supporting design, dust and vermin proof, dead front and fully inter locked with isolating switches. The panel-mounted switches shall have Interlock defeat for testing and inspection.

The panel shall be designed so as to facilitate inspection, cleaning and repairs. The clearance between phase to phase and phase to earth or metal parts shall be as per relevant IS standards. The metering instruments like volt meter, ammeter etc. shall be flush mounted and shall be of 1.0 class accuracy and of standard design size shall be 96 mm x 96. All indication lamps shall be of neon type.

The panel shall have separate cable ally and a bus bar chamber. The bus bars shall be rigid hard drawn tinned electrolytic copper & sleeved with heat shrinkable sleeves. The current density shall not exceed 1.25 amp per sq. mm. and the neutral bus shall be rated for capacity of phase bus unless otherwise stated in schedule of quantities/drawings. However, the minimum size of bars shall be 25mm x 3mm.

The panel shall be powder coated comprising of degreasing and de-scaling in sulphuric acid etc. with synthetic enamel paint for smooth finish. The color of paint shall be battle-ship Grey or as directed. The Panel shall be tested at site before commissioning. The Panel drawings shall be got first approved from Architects before taking up for fabrication.

All wiring inside the panel shall be done with switchboard copper conductors/cables solid copper links. The insulators for supporting the Bus-Bars shall be epoxy based cast resin. All hinged doors shall be earthed with flexible braided copper earth. An earth bus of copper shall be fixed along the length of the panel at the lower section. Adequate ventilation for the panel shall be provided. Logic diagram of operation of switches shall be painted on the panel. The name plates for each feeders shall be of engraved design and pasted to the respective switch gear. The letters shall not be less than 10mm size for individual feeders and not less than 18mm for the main feeders. All switchgear to be mounted in the panel shall be as per schedule of quantities.

SWITCH FUSE UNITS :

Switch Fuse Units shall be of sheet metal or iron clad with HRC fuses as described in schedule of quantities. The unit shall be of robust construction of standard specified make. design to withstand adverse working conditions. It shall have quick break type mechanism with ON and OFF position indicators of the operating handle. The switch shall be interlocked so that the unit cannot be opened in ON condition. The interior shall be so arranged that clearance from live parts are adequate and shrouded. Manufacture's instructions shall be followed for installation of switch fuse units. The switch shall be solidly earthed. The switch shall be mounted on walls on angle iron support grouted to wall. The supports shall be treated for rust treatment & painted with 2 coats of synthetic enamel paint. The height of the switch board shall be such that it is accessible for operation & maintenance.

CABLES :

Cables shall conform to IS 1554-1976. Cable shall be heavy duty, armored, PVC insulated & PVC sheathed 1.1 MV grade aluminum or copper. Cable shall be fixed with G.I. spacers & saddles at an interval of 45 cms and on every side of bends. The bending radii of cables shall be as per manufacturers instructions and in no case it shall be less than 12 times the overall diameter of the cable. Cable shall be so installed that they are not subject to mechanical damage. If there is a bend in the cable enclosed in a conduit, care has to be taken to prevent undue compression of insulation. This applies also to the top of vertical runs of longer than 5 meters where there could be compression caused by the weight of unsupported vertical cables. Cables may rest without fixing in horizontal runs or ducts or trunkings. The cables run in cable trays shall be permitted unless the cables exceed the standard drum length. Joints if so necessary shall be located in accessible position. Termination of the cables shall be done with heavy duty copper/Aluminum lugs and brass cable glands.

Cables laid under ground shall be to a minimum depth of 600 mm. It shall be ensured that cables laid underground are free of water lines, sewage lines etc. The trenches shall be at least 30 cm wide & filled with 10 cms thick of layer of dry sand on which the cable shall be laid. Further, 10 cms thick sand layer shall be put on the cable over which a brick layer shall be kept. The trench shall than be back filled with soft earth, rammed and consolidated to original level. Cable route indicators shall be laid at intervals of 20 metres and at all change in directions. For cables laid on walls aluminum tags shall be fixed showing the size of the cable and the feeder number of the cable. These tags shall be at each ends and at least one or two places at intermediate positions. The mode of measurement of the cables shall be as follows :

- i. For top entry of the cable, the measurement shall be taken up to the bottom of the switch-gear.
- ii. For bottom entry of the cable, the measurement shall be taken up to the top of that switch board. No wastage shall be allowed for measurements.

DISTRIBUTION BOARDS:

1. These shall be of sheet metal and of standard design with copper bus bars. The board shall be fixed at accessible heights. The boards shall be solidly fixed to walls/partitions, concealed or open as directed. All connections inside the distribution board shall be neatly arranged and tied with PVC strings. The MCB's shall be of 9 KA for fault level. The distribution board shall be suitably earthed. Legend shall be written on D.B. & Circuits.
2. The Distribution Board circuitry shall be as per the schematic/given in Drawing.
3. The Sheet steel used for fabrication shall be of CRCA of 14/16 SWG. The Board shall be suitable for wall mounting. It shall be totally enclosed, Dust Proof & vermin proof. The fabrication shall be as per relevant is Specifications for degree of protection by enclosure for low voltage switch-gear IP 52. The Equipment such as MCB, ELCB, Insulators, Bus-Bars shall be as per relevant is specification with latest amendments.
4. The Sheet steel shall be smoothly finished, leveled and free from flaws. All doors, removable covers shall be Gasketed all round the perimeter.
5. The Service Voltage is 440 volts & Busbar will be Electrolytic copper. The copper busbar shall be tinned through out the length.
6. The door interlock shall be provided so that it shall not be possible to open the door with breaker in close position.
7. Enough space shall be provided for termination. The minimum two earth terminals shall be provided for each D. B. The Board shall be factory wired with proper ferruling.
8. Adequate shrouds shall be provided for avoiding accidental contact with Live Terminals, Busbar etc.
9. The Conduit knockout shall be provided for Conduit Entry.
10. The guaranteed technical particulars shall be provided for the MCB & ELCB etc.
11. The engraved black anodised labels shall be provided on all feeders.
12. All Steel works shall undergo a process of degreasing, pickling in acid bath, phosphating.
13. This shall be followed by two coats of primer and two coats of final finish paint, both applied with spray. The colour shall be light battleship gray.
14. The distribution board shall have hinged door.
15. The busbar supports shall be non hygroscopic, anti tracking material.

POINT WIRING

(a) METAL CONDUITS:

1. All conduit pipes shall confirm to IS 9537 PART-II 1981. Metal conduits shall be ERW black enameled 20mm/25mm as the case may be depending upon the number of wires permitted. The conduits shall be fixed to walls/ceiling with M.S. saddles and spacers at an interval of 1 meter and on either side of bends.
2. All conduit accessories shall be 15 gauge & bends shall be of inspection type. All bends, couplers, threaded portions etc. shall be painted with anti-corrosive paint. Bends in the pipes shall be done with bending hickies.
3. All pipes shall be cleaned for sharp burrs. Switch boxes shall be of G.I. 16 G/14G. The switch boxes shall be concealed as per site requirement & as per Architect's/Architect's Instructions. Point shall be controlled with 5A switch or directly from DB as specified in schedule of quantities. Where plate type switches are not specified the switch-board shall have 3mm thick hylum sheet on which switches shall be mounted.
4. While laying the conduits in the slab before casting the slab, all drops shall be laid accurately to fall in position of the switchboard. Junction boxes shall be sand filled. All joints shall be airtight. Conduits shall be fastened to the reinforcement properly so that the conduits do not get dislocated while casting the slab. All conduits shall have 18 swg fish wire.
5. The conduit shall be of 16 gauge upto 32mm dia and 14 gauge above 32mm dia. reputed and approved make conforming is specification. Conduit shall be Heavy gauge rigid PVC with All accessories/fittings including ordinary & inspection tees; bushings, reducers, junction boxes, terminal boxes, saddles and steel supporting materials shall be of the same as of the conduit. The contractor shall have dies for threading of conduit.
6. The conduit shall run along walls, ceiling, flooring in accordance with layout drawings.
7. The conduit shall be field bend as far as possible with reasonable long radius. The conduit bends shall be free from cracks, other damage to the pipe or its coating and shall not have pipe section unduly flatten..
8. The conduit joint shall provide the structural rigidity and low electrical resistance.
9. All open conduit ends shall have bushings and all threads shall be cleaned and well painted with coating or red lead & oil. All burrs shall be smoothed and cleaned.
10. The conduit shall be supported with saddles at regular interval of 1000mm. The saddles shall be fixed with Rawal plugs and M. S. screws of 3mm size.
11. The No. of wires through a given diameter of conduit shall be as per is specification.
12. When two lengths of conduit are joined together through a coupling, running threads equal to the full length of the coupling shall be provided on any one length. Conduit length exceeding 8 meter length shall be provided with junction boxes.
13. Conduit & accessories shall be securely fixed before any operation like concrete pouring plastering etc. The conduit shall be fixed by clips which shall not cause deformation of conduits. The conduit fixing shall be at regular intervals not exceeding 1.5 meter. At the bends the fixing shall be secured by fixing clips at 150mm. All the supporting holes are to be drilled by electric drill machine.

(b) PVC CONDUITS:

The PVC Conduits shall confirm to latest IS standards and shall be of medium gauge. The conduits shall be joined with PVC adhesive at joints. The Conduits shall be fixed to walls/ceilings with GI, Spaces and Saddles at an interval of 60 cms & on either side of bends. The number of wires drawn in the conduits shall be as per table 1. The point wiring shall be controlled as

in (a) above. The wiring shall be done with 2nos. of 1.5 sq.mm (Phase & Neutral).& 2.5 sq. mm. (earth) PVC insulated, copper conductors, multi stranded and color coded with green as earth and black neutral. The circuit wiring shall be with 3 nos. of 2.5 sq. mm. PVC insulated, copper conductors, multi stranded from distribution board to switch board and the rate shall be included in the point wiring unless otherwise stated in schedule of quantities. All other details shall be as for metal conduits.

(c) CASING CAPPING/TRUNK AND TRUNKLING:

PVC casing shall be fixed, wooden partitions by means of screws spaced not more than 60 cms apart. Holes for fixing the PVC capping shall be done by drilling machine only and these holes shall be plugged with PVC plugs or grips to which the screws shall be fastened. No less than 1 inch PVC casing shall be used. All bends, tees, joints etc. shall be done in workman like manner with standard accessories. The number of wires in PVC casing capping shall be limited to a fill factor of not more than 60%. The point shall be controlled by 5 amp switch. The switch boards shall either be flush mounted with partitions or surface mounted or concealed mounted as per site requirements and as directed. The wiring shall be carried out as described in (a) and (b) above.

This wiring shall not be done for concealed wiring & wiring over the false ceiling work.

CIRCUIT WIRING

1. The Circuit wiring shall comprise of laying PVC conduit from lighting distribution board to the first switch board & pulling of wires within the conduits with 2.5 Sq.mm copper wire, PVC insulated, 100v grade wire.
2. The scope includes all materials & labour with Installation. It also includes making proper connection in the Distribution board & switch board.
3. In case of group control directly from Distribution Board, the primary point shall be from D.B. to the first point and secondary point and from first point to the next point looped. The point shall terminate into the 3 plate-ceiling rose.

SWITCH BOARD

The lighting switch board boxes shall be MS/ zinc passivated with 16 guage made suitably for controlling group of light/fixture or light control as indicated in the drawing. The switch board boxes shall be suitably in the office area as concealed type. All the switch boxes shall be provide with removable cover with proper provision of Plate/Piano type switches.

WIRING METHODS

1. The wire pulling in conduits shall be in accordance with standard practises. All the wires in a particular section by conduit shall be bunched together and pulled at a time.
2. The wires used shall be colour coded with Red wires for R phase, Yellow wire for Y phase, Blue wire for B phase Black wire for neutral and Green wire for each continuity conductor.
3. All the wires shall be purchased directly form the manufacturers and approved by the Architect.
4. All the wire shall be insulated with adequate thickness of extruded PVC.
5. All wires shall be of 1100v grade conforming to is 694 with latest amendment.
6. All the wire ends shall be ferruled with colour codes & numbers.
7. All the circuits shall be identified at both ends of the circuit.
8. A maximum of 3 lights to be switched on one switch of 5A.
9. The wiring shall be carried out with multi stranded PVC insulated copper wires of 1.5 sq. mm. 2Nos (Phase & Neutral) & 2.5 sq.mm. (Earth). In all cases the earth shall be of green color and neutral shall be black color. All wires used shall be of 660 V grade. The point wiring shall be inclusive of circuit wiring from Distribution Board to the switch-board unless otherwise stated in schedule of quantities. The circuit wiring shall be with 3 nos. of 2.5 sq.mm PVC insulated multi stranded copper conductors color coded as detailed above. The rate shall also be inclusive of any chasing as directed by the Architects/Architect/Client's Engineer to conceal the drops and finishing the same.

5A/15 AMPS. SWITCH SOCKET OUTLET WIRING

1. The Point wiring for 15 A Switch socket outlet includes running of 3 x 4.0 sq.mm PVC insulated stranded copper wire through conduit from the distribution panel board to the individual S/S/O
2. Two nos of 15 A S/S/O are to be looped in and controlled by MCB of 20 Amps in the distribution board at each floor. The circuit length shall not exceed a length of 70 meters.
3. All the wires for the S/S/O shall be pulled through separate conduit system (not to be mixed with light 5 Amps S/S/O etc.)

5 AMPS SWITCH SOCKET OUTLET

1. The point wiring for 5 Amps switch socket outlet includes running of 3 x 2.5 sq.mm copper conductor, PVC insulated, 1100v grade wires in PVC conduit from the light distribution board to the Individual socket.
2. A maximum of 6/8 Nos. socket are to be looped in & controlled by MCB in the lighting distribution board. The circuit length shall not exceed 60 meters.

15/5 A SWITCH SOCKET OUTLET

1. It shall be of approved make conforming to latest is standards. The three-pin socket shall be provided with safety shutter to prevent accidental contact with live parts.
2. The box for socket outlet shall be suitable for concealed/surface mounting and should be supplied by the Manufacturer with the switch & socket unit.

20 AMPS POINT WIRING

1. The 20 A SP MCB with Reyrolle socket is to be provided including running of 3 x 4.0 sq.mm PVC insulated stranded copper wire through PVC conduit from distribution board to the individual switch.
2. One switch is to be provided in one circuit and controlled by one MCB of 20 Amp in the distribution board at each floor.
3. All the wires for the switches shall be pulled through separate conduit system (not to be mixed light, 5 A S/S/O etc.)

TELEPHONE POINTS

1. Telephone Points shall include supply & installation of 25mm diameter PVC conduit & Accessories along with 2 pair/4 Core wire from Tag Block to Individual Point along with the Conduit. The Telephone wire shall be of oelton make or of approved sample.
2. The Conduit shall be laid concealed in slab/wall/beam column etc., from the Telephone Box to the Individual Telephone socket outlet Point as market in the Drawing.
3. In case of provision for further point for Telephone G.I. Pull wires shall be laid inside the entire length of conduit.
4. The Telephone Tag Block of M.S. shall also be provided by the Contractor including latest Type of Terminal strip cover extra as per MTNL approved list.

EARH PITS / STATION

The earthing station shall be done as per IS 3043 (1981) and as per drawing no. E1. The earth pit shall be atleast 2.5 mtrs deep with GI plate electrode shall be hot dipped of 600mm x 600mm x 6mm thick. The size for copper electrode shall be 600 x 600 x 3mm thk. An alternate layer of salt and charcoal shall be filled up to 200 mm above the top of the electrode. The electrode shall be connected with 25mm x 6 mm thick GI Flat which shall be terminated with nuts and bolts into brick masonry chamber on top. The brick masonry chamber shall be of size 300mm x 300mm x 300mm deep which will carry the finneling arrangement for watering. A GI Flat of 25mm x 3 mm from brick masonry chamber to the switch gear inside the switch room shall be laid under ground and / or fixed to walls and the rate for this shall be paid as a separate item.

INSTALLATION OF ELECTRIC FITTINGS

All electrical fittings shall be fixed with down rods or on round blocks as stated in schedule of quantities. The down rods shall be 20 mm dia and 1.6 mm wall thickness of ERW black enameled MS. The down rods shall be fixed with ball and socket joints check nuts etc. Special fixtures like spot lights etc. shall be fixed to the false ceilings as per manufacturer's recommendations. The fittings shall be connected with 3 core 0.5 sq. mm. flexible copper cord / cable from ceiling rose and suitable earthed.

TESTING OF ELECTRICAL INSULATION

The following tests shall be carried out after completion of the electrical insulation work.

- 1) Insulation Resistance Test.
- 2) Polarity Test of Switches.
- 3) Earth Continuity Test.

1) Insulation Resistance Test : The insulation resistance shall be measured by applying between earth and whole system of conductors or any section thereof with all fuses in place and all switches closed (except in earthed concentric wiring) all lamps in position and both poles electrically connected together., or direct current pressure of not less than twice the working pressure, provided that it need not exceed 500 volts for medium voltage circuits, be applied. Where the supply is derived from 3 wire DC or Poly phase A.C. System, the neutral pole of which is connected to the earth either direct or through added resistance, the working pressure shall be deemed to be that which is maintained between the phase conductor and the neutral. The insulation resistance measured in mega ohms between all conductors connected to one pole of phase conductor of the supply and all the other conductor and switches in off position it's value shall be not less than as specified below :

The insulation resistance measured in mega ohms shall not be less than 50 mega ohms divided by the number of outlets or when PVC insulated cables are used for wiring , 12.5 mega ohms divided by the outlet subject to a minimum value of 1 mega ohm.

A preliminary and similar test may be made before lamps etc. are installed and in this event the insulation resistance to earth shall not be less than 100 mega ohms divided by the number of outlets or when PVC insulated cables are used 25 mega ohms divided by the number of outlets subject to a minimum of 1 mega ohm.

2) Polarity Test of Switches : In a 2 wire system a test shall be made to verify that all switches in every circuit are fitted in the same conductor through out and such conductors shall be labelled or marked for connection to the phase conductor or to the non earthed conductor of supply.

In a 3 wire or 4 wire insulation a test shall be made to verify that every non linked single pole switch is fitted in a conductor which is labelled or marked to one of the phase conductor of supply.

3) Earth Continuity Test : The Earth Continuity Conductor including metal conduits and metallic envelopes of cables in all cases shall be tested for electric continuity and electrical resistance of the same along with the earthing lead but

excluding any added resistance or earth leakage circuit breaker measured from connection with earth electrode to any point in the earth continuity conductor in the completed insulated shall not exceed 1 ohm.

POWER FACTOR CORRECTION PANEL

The power factor correction panel shall be fabricated from sheet steel & powder coated. The panel shall be compartmentalized with tinned copper bus bars PN as described for power panels.

The power capacitors shall be APP type, low loss, 3 phase, delta connected and self-discharged type. The power factor control shall be done by automatic power factor control relay for controlling the power factor within the set limits by auto switching of required capacitor. The required Capacity / P.F- Stock Holding shall be as per schedule of quantities. The P.F shall be automatically corrected to near Unity.

The C.T. ratio given in the schedule / diagram is indicative. The same shall be matched for correct operation depending upon the operating load. The relay shall be totally microprocessor based for setting the desired target power factor band. The APFC relay shall have indications like power ON, low current etc & shall be of required stages as per schedule of quantities. The P.F Panel shall have Auto Manual switching facility.

The general specification shall be as follows :

- i. System supply voltage 415 volts.
- ii. C.T. secondary rating 5 A, 5 VA Burden.
- iii. Output switching capacity 5A at 230 V AC & 2A at 440 V AC, Operating temperature, 10 degree Centigrade to 50 degree Centigrade. Accuracy better than 1%. Low current release 10% of full rated C.T.
- iv. Switching time between stages 4 to 6 seconds.
- v. Range of indications of PF 0.5 lag to 0.5 lead digital.
- vi. Display LED indications.
- vii. Range of target P.F. setting 0.7 to 0.99.
- viii. Switch for auto / manual operation.
- ix. Indications for selection of stages.
- x. Selection of dead band.

PREFERRED MAKES OF MATERIALS

1. All materials to be supplied by the contractor shall confirm to the relevant Indian Standard and bear "ISI" marking distinctly. However for the guidance of the Contractor some of the preferred makes of materials are as follows.
2. All materials shall be of the first quality.
3. Wherever Contractor proposes to use 'equivalent' makes (i.e. other than specified) the same shall be done only after prior approval from STOCK HOLDING. STOCK HOLDING may consult Architect before giving approval. Any additional expenditure, time due to this will be on Contractor's account and no claims will be entertained.
4. Read "or equivalent approved" at the end of the list of approved manufacture / sub-contractor / brand for every materials.

<u>SR. NO. MATERIAL</u>	<u>APPROVED MANUFACTURES / SUPPLIERS</u>
1. SFU/ Isolator switch	EE/L&T/Siemens
2. L.T. Panels	EE/L&T/ Siemens / As approved
3. Meters	AE/MECO/ Rishab/ Silkon/ UE
4. DB (HRC Fuse)	Legrand/L&T
5. DB (MCB)	Legrand/L&T
6. Wires	Finloex / Polycab/Polycab
7. Conduits	Nihir/ISI
8. Switches /Sockets	Anchorwoods/Crabtree/ABB
9. Lugs	Dowell/Jainson
10. Telephone cables	Finloex/ Delton/ MTNL approved
11. Decorative lights (spot lights/ picture lights wall)	Crompton/Havells/Panasonic
12. Fire detectors	Appolo Honrywell
13. Security system	Shellain / Radioncis sentrol
14. ELCB/RCCB	Legrand/L&T
15. Telephone Tag-block	Krone
16. NCCBS	L&T/EE/Crompton
17. Air Circuit Breaker	L&T Siemens /EE
18. Changeover Switches	Siemens / Blcon/ Kayee
19. Contactors	Siemens /L&T
20. Music speakers	Phillips/ Ahuja
21. Amplifiers	Phillips /Ahuja
22. Elec. Fittings & fixtures	Crompton/Havells/Panasonic
23. PL/ Spot Lights fittings	Crompton/Havells/Panasonic
24. Copper Cable (Conductor)	Polycab / finloex/RR Kabel
25. Flourscent Lights, PL Lights and Lamps etc.	Crompton/Havells/Panasonic
26. MCB/ ELCB	Legrand/L&T
27. Main switcher (sheet metal boxing)	L&T
28. Ceiling Fan	Crompton/ Usha, Bajaj /Orient
29. Wall fan	Crompton/ Usha, Bajaj/ Orient /Almonard
30. Exhaust fan	Unique/Crompton/GEC
31. Gland Flange Type	BRACO
32. Casing Caping Patti	PRESTO PLAST

PROPOSED LAYOUT OF SATELLITE BRANCH

STOCK HOLDING CORPORATION OF INDIA LIMITED, SATELLITE BRANCH, AHMEDABAD

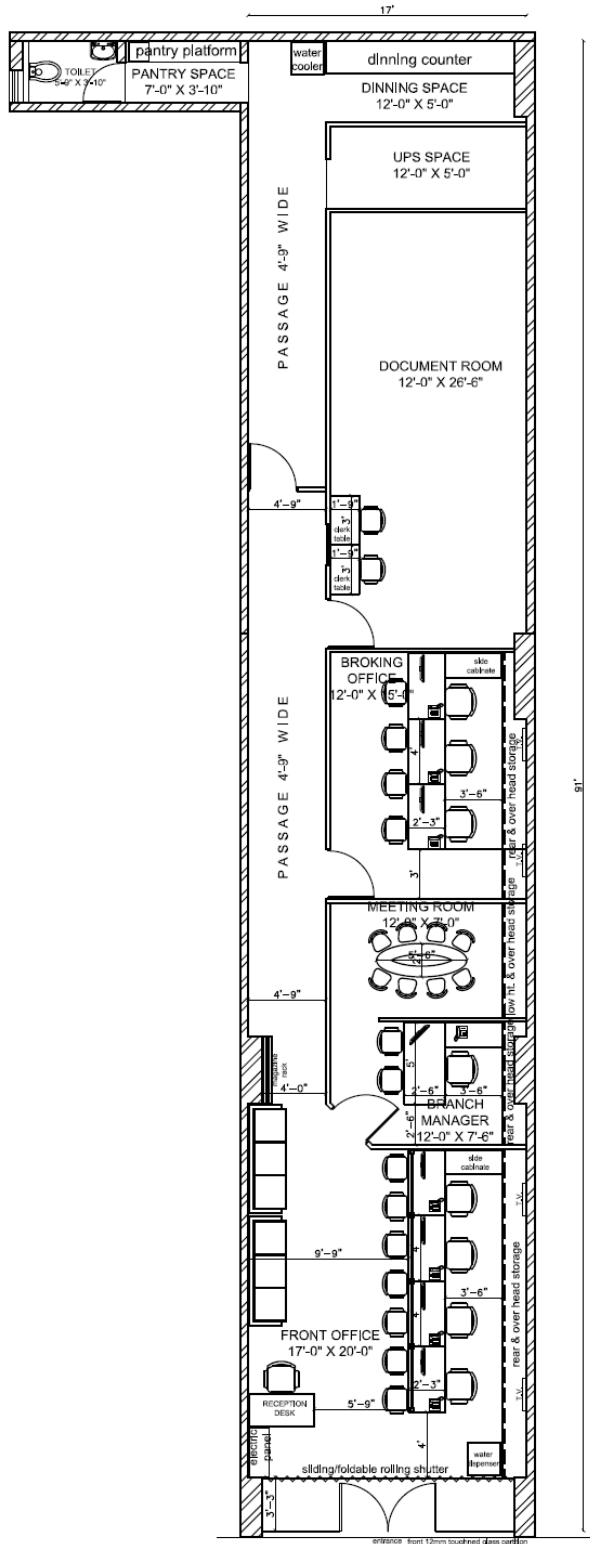

SECOND FLOOR PLAN
ALTERNATIVE - 4A



BIMAL TALATI
ARCHITECTS & INTERIOR DESIGNERS
304, PRESIDENT HOUSE,
GPF, C.N. VIDYALAYA,
AMBAWADI,
AHMEDABAD - 380 006,
INDIA.
PHONE:- (079) 26421682, 94089 94093
Email - bimaltalati@gmail.com